

exhibition road newsletter

Issue 18:
August 2011

Keeping you informed

Road layout

Earlier this year, Transport for London (TfL) consulted on proposed locations for route 360 bus stops in Exhibition Road. It received 14 responses during the six week consultation which finished on 10 June. Full details of the consultation can be seen at consultations.tfl.gov.uk/buses/route-360. After considering these responses TfL has now confirmed that the 360 bus will stop at the following locations:

Northbound – outside the Science Museum
Southbound – outside the Exhibition Road entrance to the V&A

Now these locations have been fixed we can finalise where the other on-street facilities, such as parking bays and cycle racks, can be placed. The plan on the right shows our proposals. We believe this layout will balance the needs of all road users without making the street seem cluttered or cramped. We will provide residents' parking, blue badge parking, cycle parking and cycle hire as well as seating.

We will be carrying out the statutory consultation on the Traffic Management Orders in September. For a larger, easier to read plan and more details please see our website at www.rbkc.gov.uk/exhibitionroad

We're sure you will all want to wish a speedy recovery to electrician Ashley Evans who was injured while erecting street signs on 3 August. He's recovering in hospital. Balfour Beatty are carrying out a thorough investigation into the accident and will be submitting a full report to the Health and Safety Executive shortly.

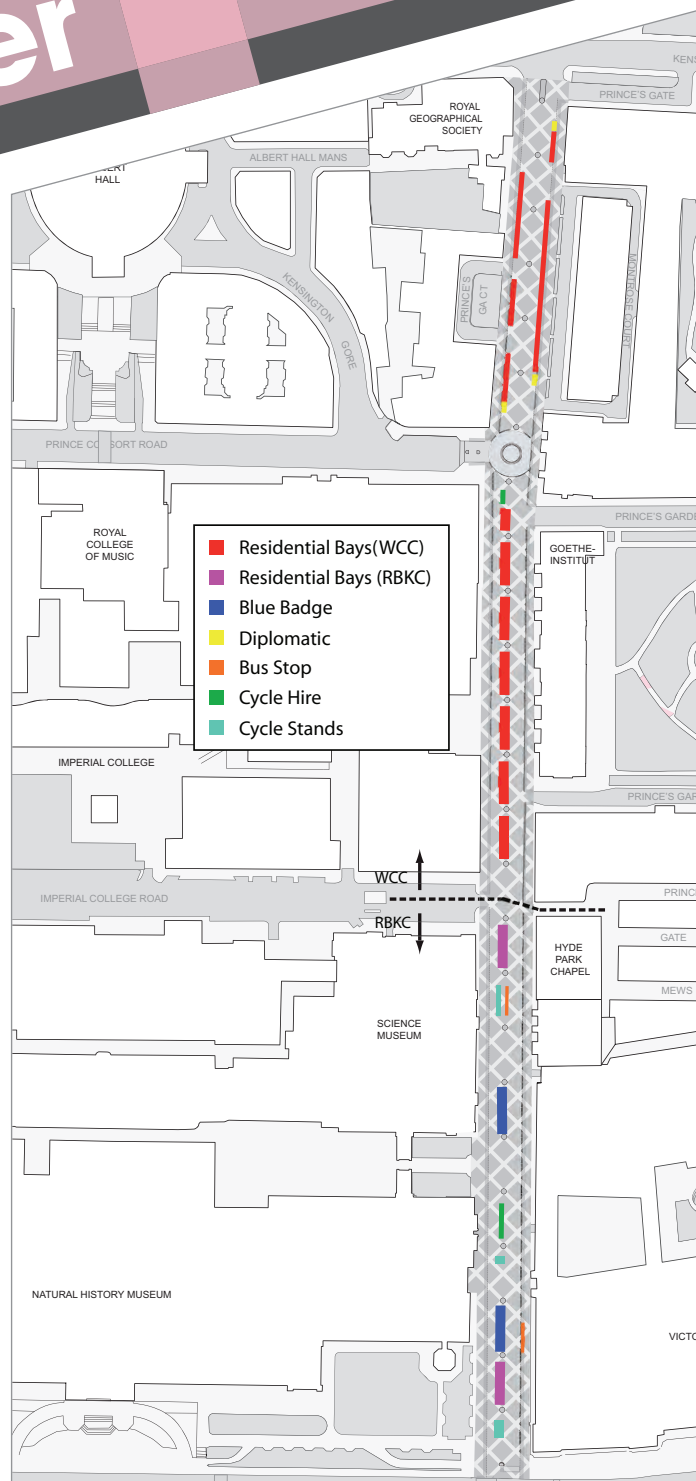

exhibitionroad@rbkc.gov.uk
Shirley Long – 020 7361 3238
www.rbkc.gov.uk/exhibitionroad
[www.twitter.com/RBKC_ExRd](https://twitter.com/RBKC_ExRd)



THE ROYAL BOROUGH OF
KENSINGTON
AND CHELSEA



Ground workers laying the road base

Bartók celebration



Imre Varga's statue of Béla Bartók will be re-unveiled on the pavement outside Malvern Court, South Kensington, at 2pm on Saturday 24 September. The Peter Warlock Society are arranging the event with Tamás Vásáry and David Mellor. The Chelsea Ballet will perform *The Bracelet*, choreographed to Chris Mowat's brass arrangement of the last six of Bartók's *Mikrokosmos*.

All are welcome to this enjoyable afternoon. For more details of other events celebrating the work of Béla Bartók and Peter Warlock see www.peterwarlock.org



A face on the street

This is Paul Aley from Kent who drives and operates the concrete pourer used on the Exhibition Road site. He works for a family run company from Essex called Camfaud who supply concrete pourers throughout the UK. The German-made Putzmeister machine we are using on Exhibition Road has a reach of 29 metres outwards and can stretch up to 32 metres high. It can pour 16 tons of concrete in just over two minutes making it hard work for the ground workers, who have to spread the concrete, to keep up. Paul has been doing this work for over nine years and travels all over the south east.

Open House London

Once again Exhibition Road will be showcased in Open House London, a city-wide celebration of the capital's buildings, places and neighbourhoods. As last year, the tour will be led by David McDonald from RBKC Planning Department and Shirley Long from the Exhibition Road Project Team. The walk will look at the area's Victorian architectural heritage as well as the streetscape project. To join the walk on 17 September or for more details of Open House London weekend see www.openhouselondon.org

Crossing Pelham Street

In last month's newsletter we told you that we would start work on the raised entry treatment at the Pelham Street junction in autumn this year. We intended to start at the end of September so we could finish works before the Christmas moratorium for Old Brompton Road which starts on 2 December. Unfortunately, National Grid's works outside the Oratory on the A4 that were due to finish in September have been delayed and will not finish until mid to late October.

We cannot start work on Pelham Street until these works are cleared because we need to divert traffic onto the A4 Thurloe Place while Pelham Street is closed. So we will start work on the Pelham Street junction in January 2012.

This newsletter is delivered to all homes, businesses and organisations in the Exhibition Road area. Every month we will let you know how the project is progressing, as well as introducing you to some of the people and the work they are carrying out on this £25 million project.



MAYOR OF LONDON

City of Westminster