

61 Courtyard NOT SURVEYED

Proposed gable end roof with parapet coping to match roof at No.26

Dashed line indicative of existing hipped roof

Proposed lead clad dormers with eaves roof lights

Double dashed line indicative of existing dormers

Proposed conservation roof lights

Proposed lead clad dormers with glazed dormer cheeks and eaves roof lights

Double dashed line indicative of existing pitched, sloped roof lights.

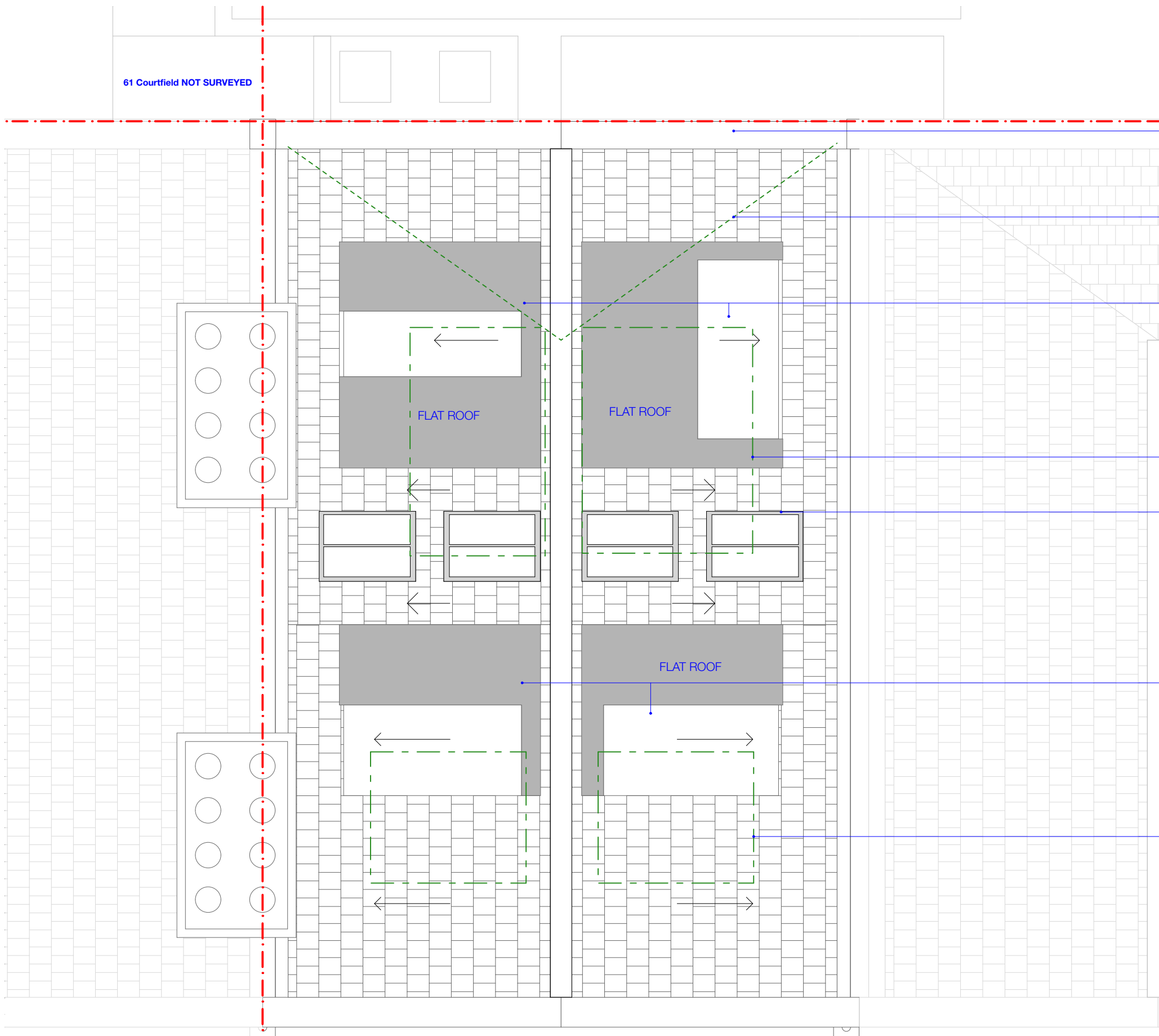

REV	DATE	DRAWN	AMENDMENT

**Granit Chartered Architects**  
Architecture + Design

Studios 18-19, 16 Porteus Place,  
Clapham, London SW4 0AS

t +44 (0) 20 7924 4555  
e info@granit.co.uk  
w www.granit.co.uk

© GRANIT CHARTERED ARCHITECTS LTD

**Notes**  
IF THIS DRAWING HAS BEEN ISSUED 'FOR CONSTRUCTION' DO NOT SCALE DIRECTLY FROM IT. ALL DIMENSIONS TO BE CHECKED ON-SITE, PLEASE CONTACT ARCHITECT IF YOU REQUIRE CONFIRMATION OF ANY DIMENSIONS. ANY DISCREPANCIES TO BE RAISED WITH CONTRACT ADMINISTRATOR.

THIS DRAWING HAS BEEN PRODUCED FOR THE NAMED CLIENT AND NAMED PROJECT AND IS NOT INTENDED FOR USE BY ANY OTHER PERSON OR FOR ANY OTHER PURPOSE.

For **Yasmine & Oliver Westmacott**  
Project **25 Astwood Mews**  
Address **25 Astwood Mews, Kensington, London, SW7 4DE**

Purpose **FOR PLANNING**  
Drawing **Proposed Roof Plan**

Drawing No. **1648/P/105**

Revision  
**A**

Drawn **MG**  
Scale **1:50 @ A3** Date **08/05/2017**

File **1648\_Astwood\_Mews\_CURRENT.pln**

26 Astwood Mews

25a Astwood Mews

24 Astwood Mews

