

TREVOR | LAHIFF ARCHITECTS

geneva house
99 knatchbull road
london SE5 9QU
design@tlastudio.co.uk
www.tlastudio.co.uk
T +44(0)20 7737 6181
F +44(0)20 7326 0349

CLIENT
RAB PENSION TRUST

- TREVOR LAHIFF ARCHITECTS
- Do not scale off this drawing, use figured dimensions only. All dimensions and levels to be checked on site. Contractor and/or subcontractor supplier is obliged to promptly report all errors, discrepancies and omissions to TLA.
 - Issued only for purpose indicated.
 - The drawing is to be read in conjunction with consultants drawings and specifications before proceeding with works. All consultants informed to be referred to ensure compliance with local and statutory building regulations and BRE/BSI standards.
 - This drawing is copyright and sole property of TLA and may not be copied, altered or reproduced in any way or passed to a third party without our written consent.
 - The main contractor should be conversant with the statutory obligations under the CDM regulations.
 - The dimensions shown on this drawing have been based on the measurements provided by an independent survey company.
 - Samples to be provided by main contractor for TLA approval.
 - TLA to approve all drawings and rods prior to construction.

PROPOSED

SPECIFIC NOTES:

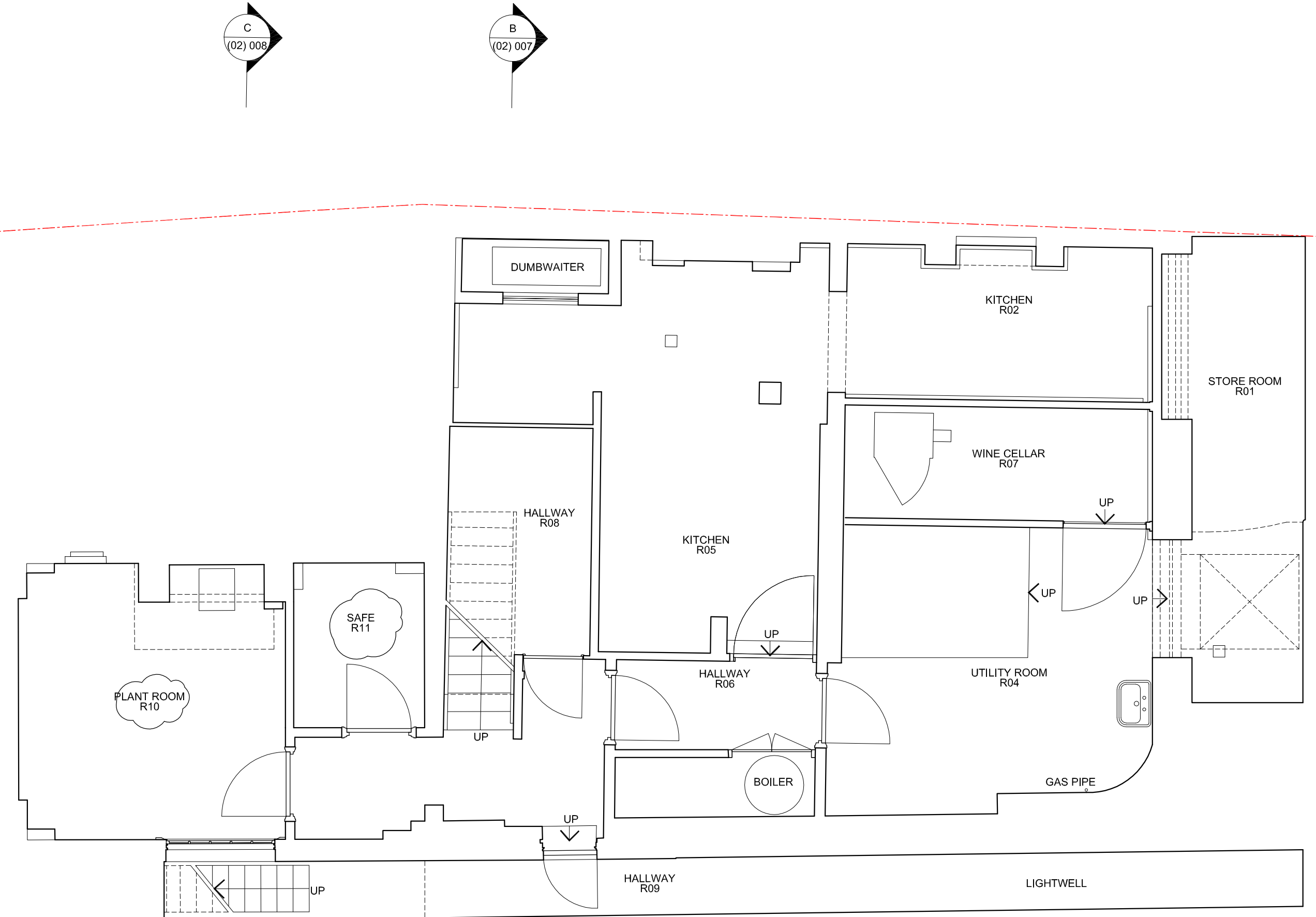

PS	19.01.12	PLANNING ISSUE	RJ	KW
REV	DATE	DESCRIPTION	DWN	CHD

ADDRESS
9 PHENE STREET
LONDON SW3 5NY

TITLE
PROPOSED BASEMENT
FLOOR PLAN

STATUS
PLANNING
DRAWN BY
THD

SCALE
1:50@A1 & 1:100@A3
CHECKED BY
KW

DATE
JUNE 2011
DWG
006
REV
P5

PROJECT No.
822
(20)

