



TP/99/0201 (2)

Dimensions are not to be scaled from this drawing

This drawing is the property of The Colman Partnership and copyright is reserved by them. The drawing is issued on condition that it is not to be copied, reproduced or used in any way without the prior consent in writing of The Colman Partnership.

Revision Date

REV A - SUBSTATION ADDED. DETAIL NOTATION ADDED. CONSTRUCTION ISSUE 4.5.99 SKC

REV B - PAVER AND LIGHTING TYPES CLARIFIED. 18.5.99 SKC

REV C - LEB SUB STATION RELOCATED AND CAR PARK ENTRY ALTERED. 20.7.99 SKC

REV D - GATE AT SUBSTATION CHANGED TO FOLDING DOOR. 22.10.99 MR

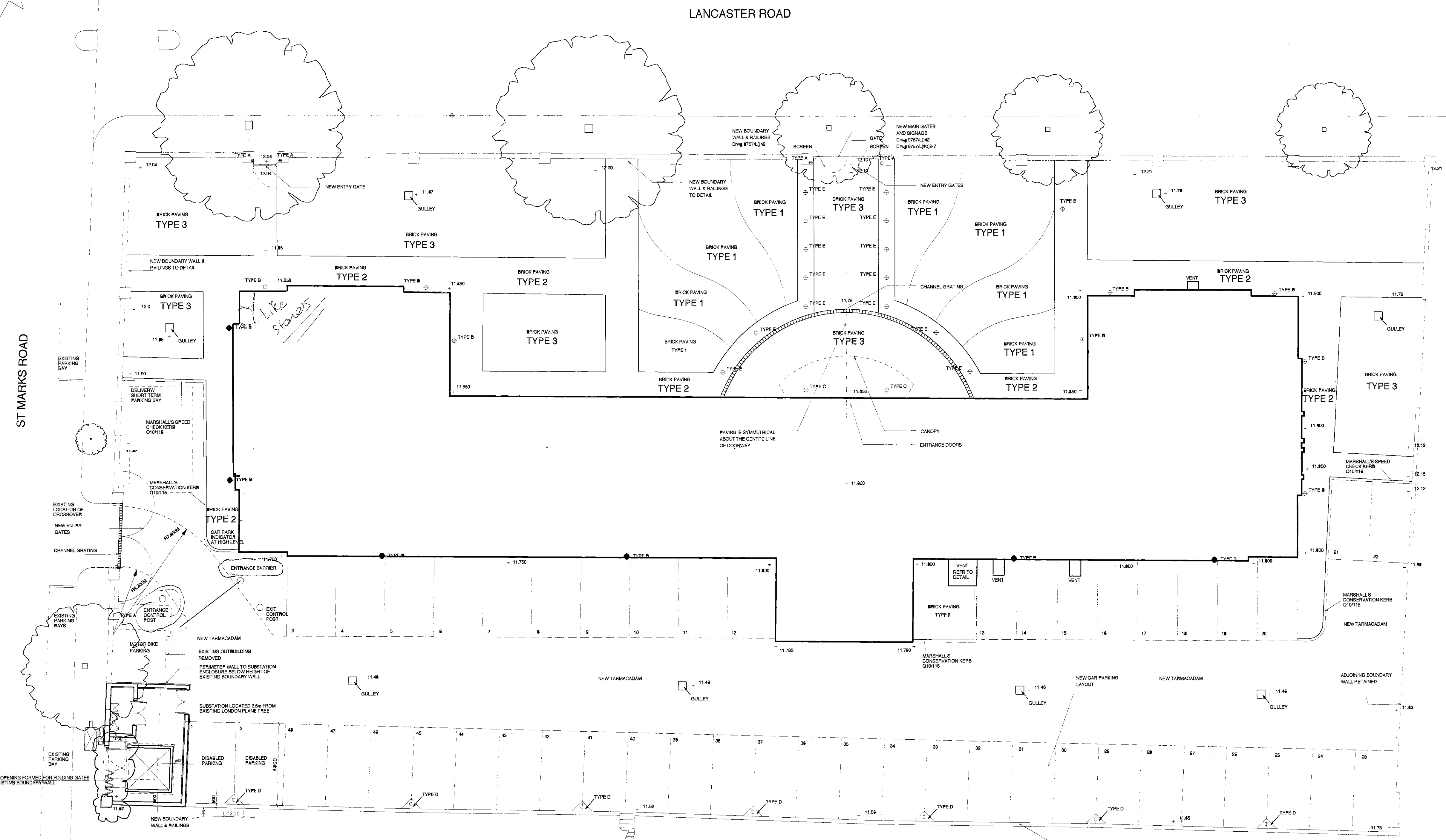
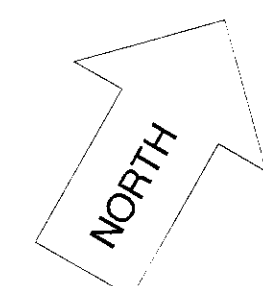

|       |   |       |    |    |    |     |     |     |     |     |     |     |
|-------|---|-------|----|----|----|-----|-----|-----|-----|-----|-----|-----|
| 1:1   | 0 | 10mm  | 20 | 30 | 40 | 50  | 60  | 70  | 80  | 90  | 100 | 110 |
| 1:10  | 0 | 1m    | 2  | 3  | 4  | 5   | 6   | 7   | 8   | 9   | 10  | 11  |
| 1:50  | 0 | 100mm | 2  | 3  | 4  | 5   | 6   | 7   | 8   | 9   | 10  | 11  |
| 1:200 | 0 | 200mm | 40 | 60 | 80 | 100 | 120 | 140 | 160 | 180 | 200 | 220 |
| 1:250 | 0 | 250mm | 40 | 60 | 80 | 100 | 120 | 140 | 160 | 180 | 200 | 220 |
| 1:250 | 0 | 250mm | 40 | 60 | 80 | 100 | 120 | 140 | 160 | 180 | 200 | 220 |

Key to ground treatments

- Type 1 - Baggeridge Buff Dragfaced Chamfered Pavers ( K 272 )
- Type 2 - Baggeridge Buff Multi Dragfaced Chamfered Pavers ( K 274 )
- Type 3 - Baggeridge Red Brindied Dragfaced Chamfered Pavers ( K 277 )
- Tarmac
- Type 4 - Baggeridge Blue Dragfaced Chamfered Pavers ( S182 )
- Marshalls Mono Ltd 'Speckcheck' Block Pavors
- Marshalls Mono Ltd, Precast concrete 'Conservation Kerb'

R.B.K.&C.  
TOWN PLANNING  
- 8 NOV 1999  
RECEIVED

Key to Light Fittings

- Type A -
- Type B -
- Type C -
- Type D -
- Type E -
- Type F -

DELEGATED  
APPROVAL  
3 NOV 2000

The COLMAN Partnership  
ARCHITECTS  
7-8 QUEEN STREET LONDON, W1P 9JZ  
Tel: 0181 252 2525 Fax: 0181 252 2525

Project HOLMES PLACE  
HEALTH CLUB  
NOTTING HILL

Title SITE LAYOUT

Scale NTS 1:150 Checked by Manager

Date 18.5.99 Drawn by SKC Checked by SKC

Drawing No 9757/L(90)1 Revision 0

CAD Filename 9757/L(90)1.dgn

TP/99/0201/c

Dimensions are not to be scaled from this drawing

This drawing is the property of The Colman Partnership and Copyright is reserved by them. The drawing is loaned on condition that it is not copied or disclosed by or to any unauthorized persons without the prior consent in writing of The Colman Partnership

Revision \_\_\_\_\_ Date \_\_\_\_\_

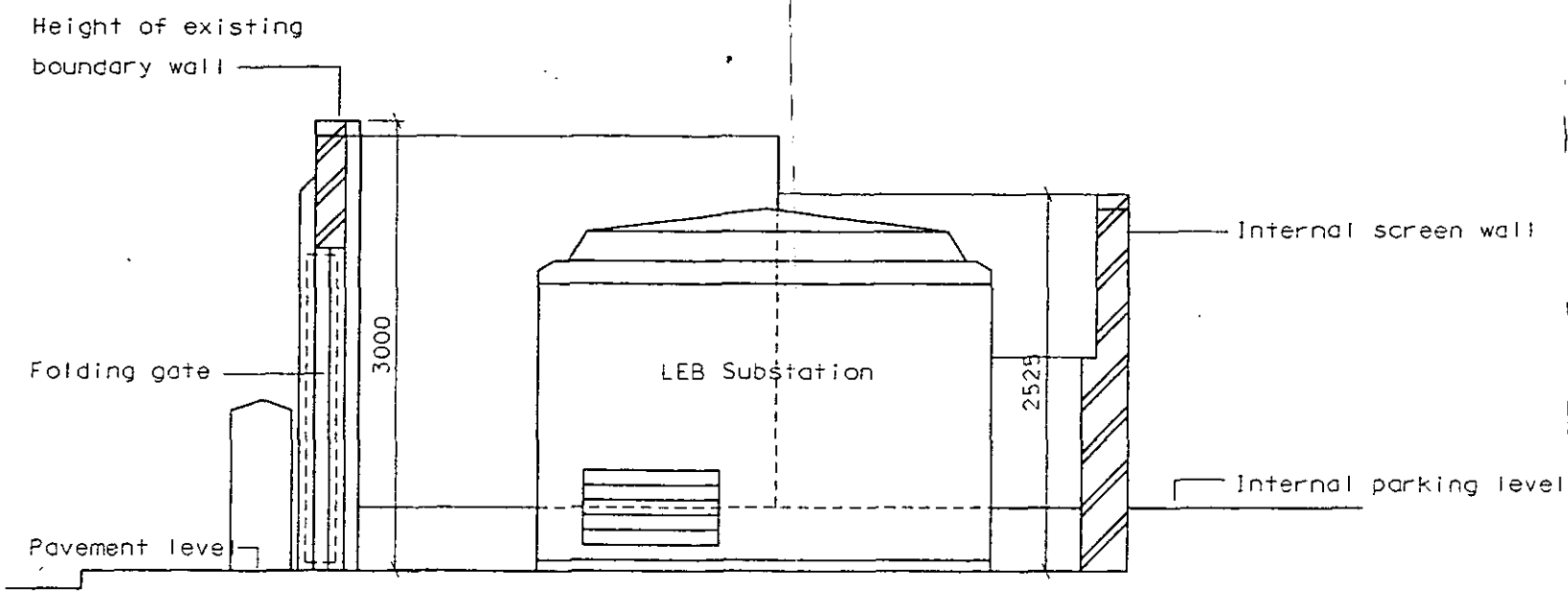

Existing building line  
SECTION THROUGH SUBSTATION ENCLOSURE

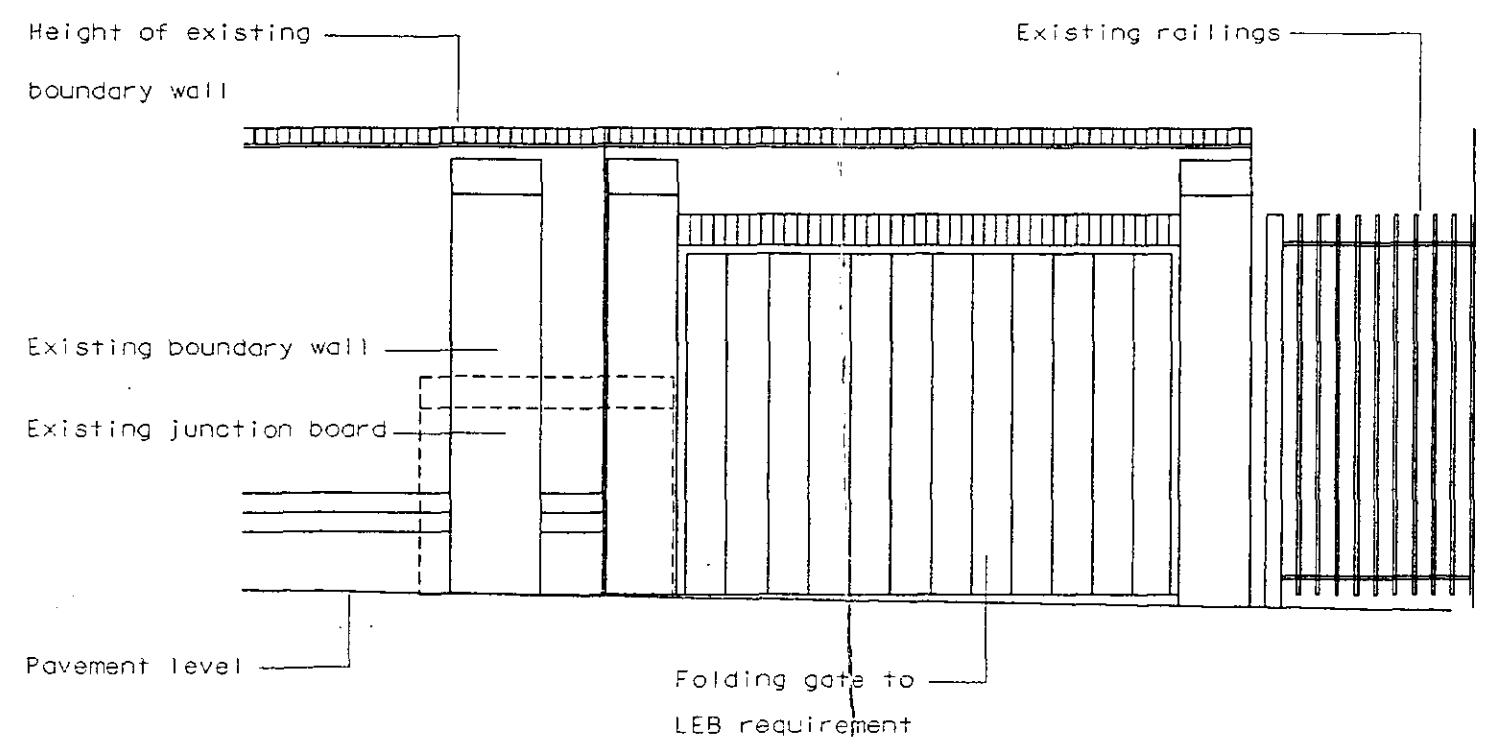

ELEVATION TO SUBSTATION ENCLOSURE

|        |   |       |     |     |     |      |      |      |      |      |      |      |      |      |      |
|--------|---|-------|-----|-----|-----|------|------|------|------|------|------|------|------|------|------|
| 1:1    | 0 | 10mm  | 20  | 30  | 40  | 50   | 60   | 70   | 80   | 90   | 100  | 110  | 120  | 130  | 140  |
| 1:100  | 0 | 1m    | 2   | 3   | 4   | 5    | 6    | 7    | 8    | 9    | 10   | 11   | 12   | 13   | 14   |
| 1:5    | 0 | 100mm | 200 | 300 | 400 | 500  | 600  | 700  | 800  | 900  | 1000 | 1100 | 1200 | 1300 | 1400 |
| 1:50   | 0 | 1m    | 2   | 3   | 4   | 5    | 6    | 7    | 8    | 9    | 10   | 11   | 12   | 13   | 14   |
| 1:20   | 0 | 200mm | 400 | 600 | 800 | 1000 | 1200 | 1400 | 1600 | 1800 | 2000 | 2200 |      |      |      |
| 1:200  | 0 | 2m    | 4   | 6   | 8   | 10   | 12   | 14   | 16   | 18   | 20   | 22   |      |      |      |
| 1:1250 | 0 | 10m   | 20  | 30  | 40  | 50   | 60   | 70   | 80   | 90   | 100  | 110  | 120  | 130  | 140  |
| 1:2500 | 0 | 20m   | 40  | 60  | 80  | 100  | 120  | 140  | 160  | 180  | 200  | 220  | 240  | 260  | 280  |

**DELEGATED APPROVAL**  
3 NOV 2000

*pp/29/0201/A*

**The COLMAN Partnership**  
ARCHITECTS  
7-8 Midford Place, London W1P 9SE  
Telephone Number 0171 583 3325 Fax Number 0171 583 3615

Project: **80imes Place Notting Hill**

Title: **LEB Substation Enclosure**

Scale: **1:20**

Date: **05.11.98**

Drawing No.: **9757L(90)14**

CAD Filename: \_\_\_\_\_

Checked Manager: \_\_\_\_\_

Drawn by: **pb**

Checked/Proj. Arch: \_\_\_\_\_

Revision: \_\_\_\_\_

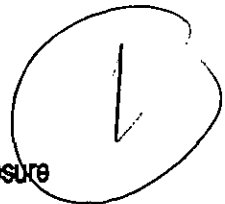

REV A - SUBSTATION ADDED, DETAIL NOTATION ADDED, CONSTRUCTION ISSUE 4.8.99 S/C  
 REV B - PAVEMENT AND LIGHTING TYPES CLARIFIED, 18.5.99 S/C  
 REV C - LEB SUB STATION RELOCATED AND CAR PARK ENTRY ALTERED 20.7.99 S/C  
 REV D - GATE AT SUBSTATION CHANGED TO FOLDING DOOR 22.10.99 NR

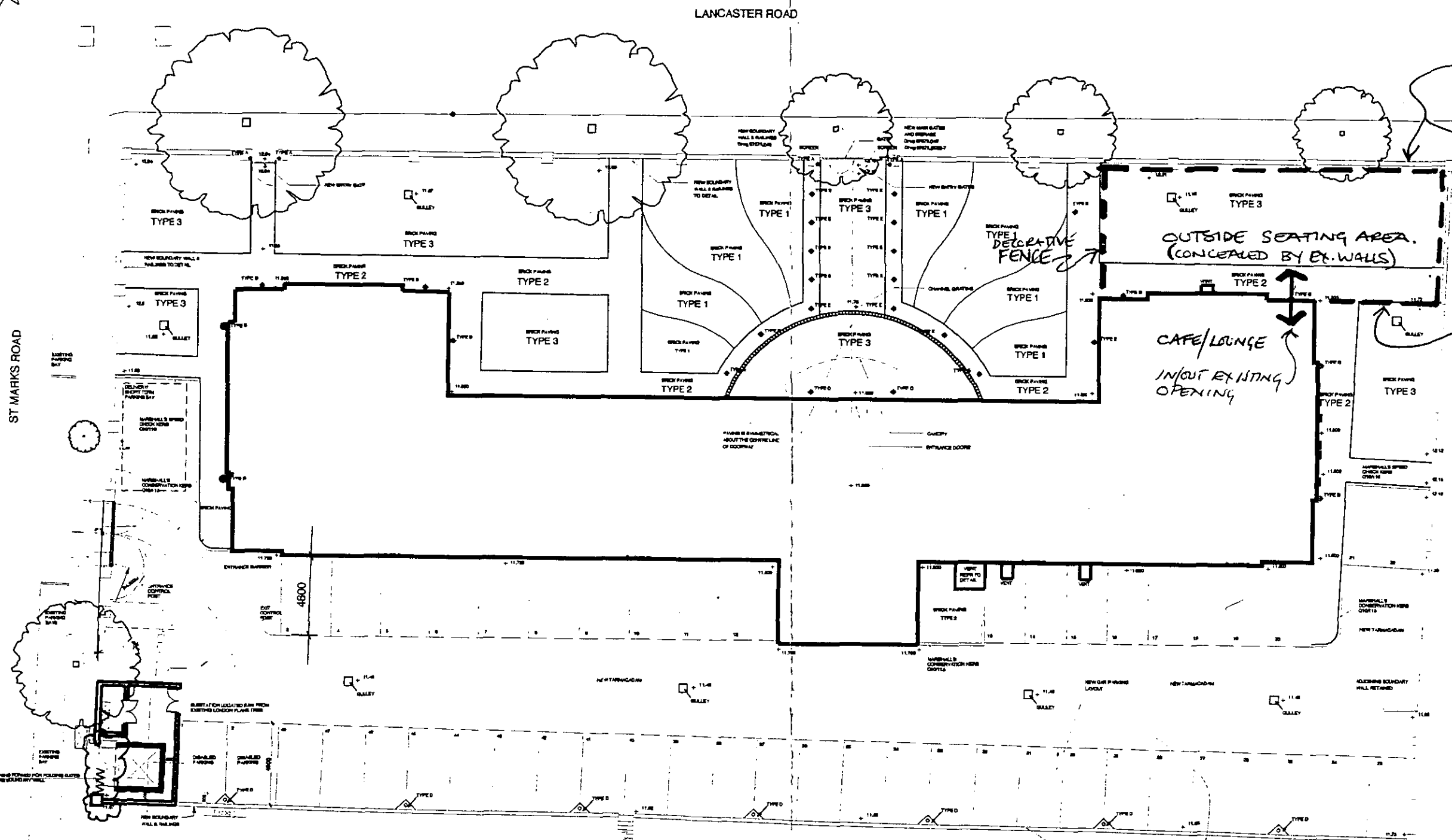

EXISTING HIGH BOUNDARY WALLS TO W, N & E SIDES

OUTSIDE SEATING AREA (CONCEALED BY EX. WALLS)

CAFE/LOUNGE IN/OUT EXISTING OPENING

DECORATIVE FENCE

Key to Light Fittings

- Type A -
- Type B -
- Type C -
- Type D -
- Type E -
- Type F -

Key to ground treatments

|  |        |   |       |     |     |     |      |      |      |      |      |      |      |     |     |     |
|--|--------|---|-------|-----|-----|-----|------|------|------|------|------|------|------|-----|-----|-----|
|  | 1:1    | 0 | 10mm  | 20  | 30  | 40  | 50   | 60   | 70   | 80   | 90   | 100  | 110  |     |     |     |
|  | 1:100  | 0 | 1m    | 2   | 3   | 4   | 5    | 6    | 7    | 8    | 9    | 10   | 11   |     |     |     |
|  | 1:5    | 0 | 100mm | 200 | 300 | 400 | 500  |      |      |      |      |      |      |     |     |     |
|  | 1:50   | 0 | 1m    | 2   | 3   | 4   | 5    |      |      |      |      |      |      |     |     |     |
|  | 1:20   | 0 | 200mm | 400 | 600 | 800 | 1000 | 1200 | 1400 | 1600 | 1800 | 2000 | 2200 |     |     |     |
|  | 1:200  | 0 | 2m    | 4   | 6   | 8   | 10   | 12   | 14   | 16   | 18   | 20   | 22   |     |     |     |
|  | 1:1250 | 0 | 10m   | 20  | 30  | 40  | 50   | 60   | 70   | 80   | 90   | 100  | 110  | 120 | 130 | 140 |
|  | 1:2500 | 0 | 20m   | 40  | 60  | 80  | 100  | 120  | 140  | 160  | 180  | 200  | 220  | 240 | 260 | 280 |

LOCATION OF PROPOSED OUTSIDE SEATING AREA

COLMAN ARCHITECTS

Project: HOLMES PLACE HEALTH CLUB NOTTING HILL

Site: SITE LAYOUT

Scale: NTS

Date: 18.5.99

Drawing No: 9757A(90)1

Drawing By: [Signature]

Drawing Date: 18.5.99

Drawing Scale: NTS

Drawing No: 9757A(90)1

Drawing Date: 18.5.99

Drawing Scale: NTS

9757 1 (90) 01 & 08.dgn Apr. 10, 2000 14:27:53

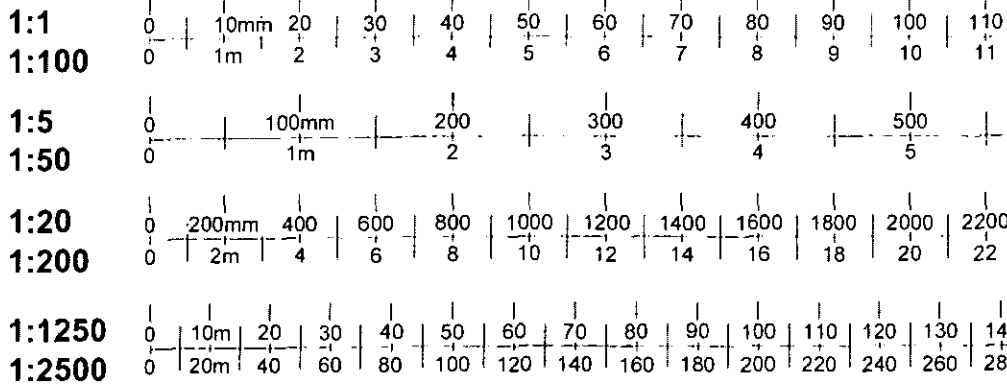

Ordnance

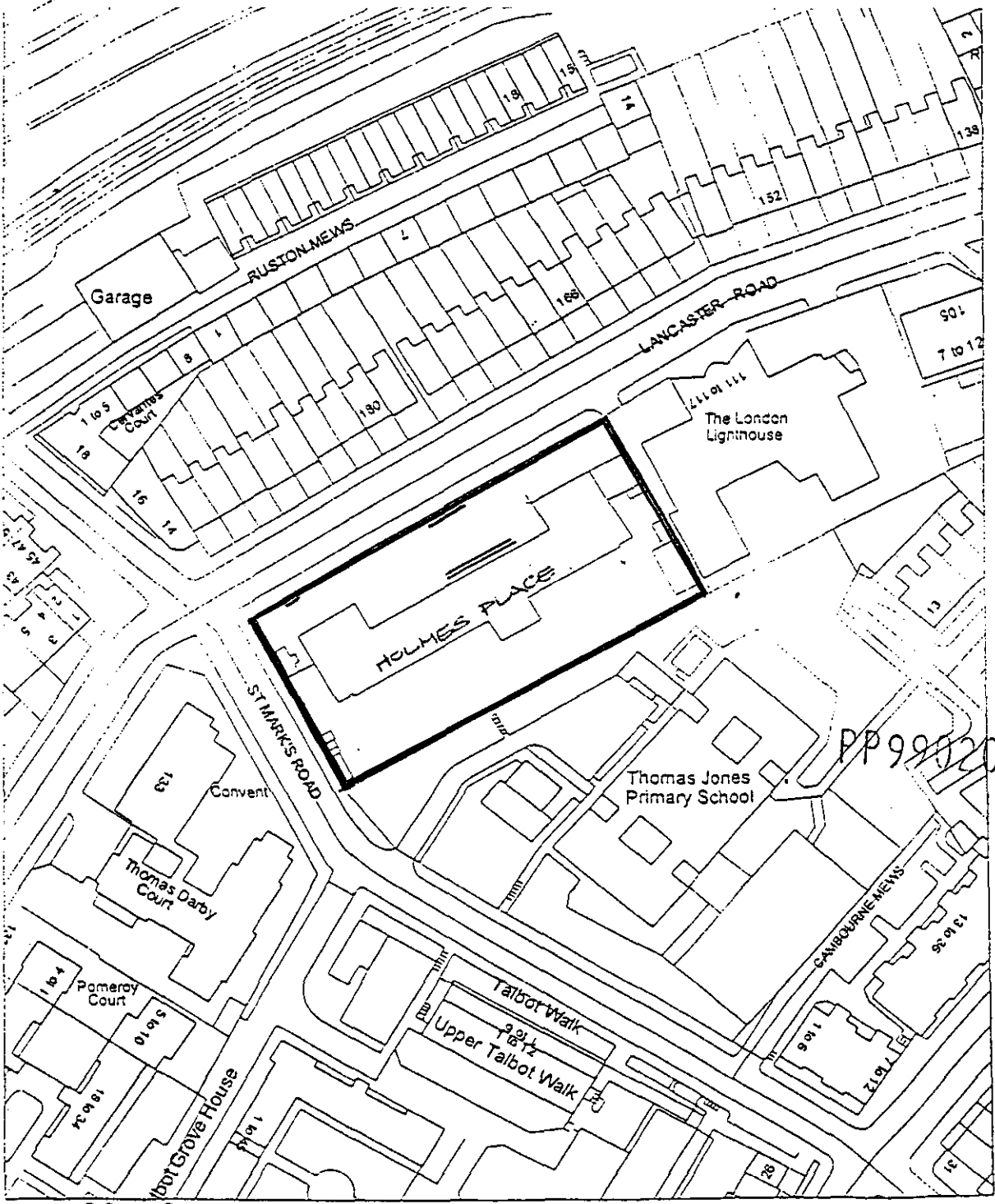

PP999201

© Crown Copyright 1997 Based on Ordnance Survey digital data  
 Survey Scale - 1:1250 Plotted Scale - 1:1250



9757/L(LP)01 - SITE LOCATION PLAN

