

BUILDING SITE PLAN AMENDMENTS	INTL.	DATE	SUPP
REDRAWN BY EL 43	RJP	21.8.77	1
SURVEYED	K	22.4.88	2
SURVEYED	K	20.8.92	3

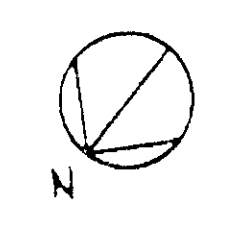
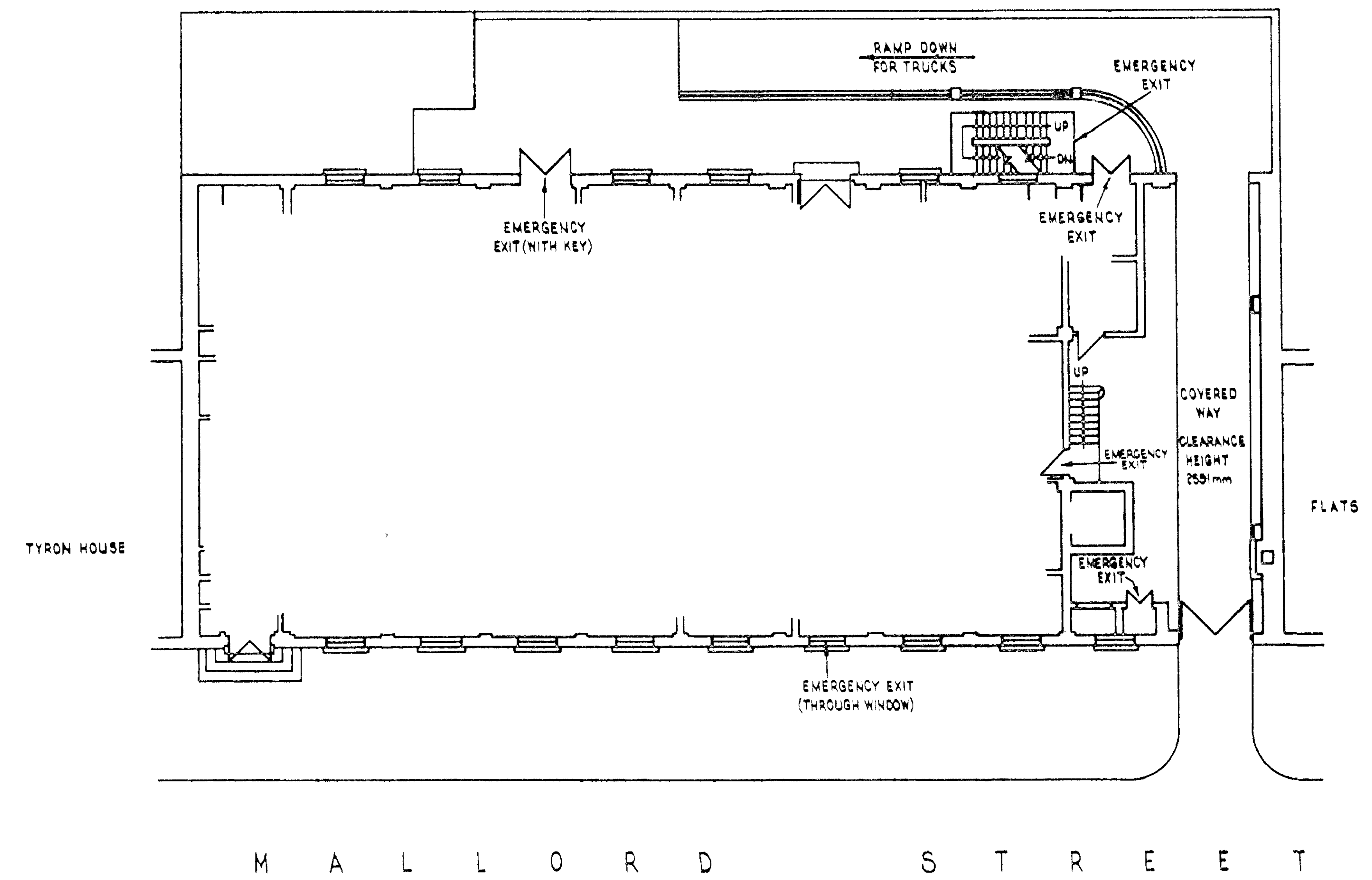

PP101/460

DELEGATED APPROVAL
27 JUL 2001

RECEIVED
- 2 JUL 2001

SITE AREA = 986.0 M²

ALL DIMENSIONS IN MILLIMETRES

SCALE = 1:100

THE POST OFFICE 19



APPROVED	CHELSEA 352 MALLORD ST, LONDON, SW8 6J	
DRN		
CKD		
ISSUED	AMENDMENT	DATE
A 2721	POST OFFICE TELEPHONES L.T. REGION SOUTH CENTRAL AREA	

SITE PLAN

5000 0 5000 10000 15000 20000 APPROX.

