

TOWN & COUNTRY PLANNING ACT 1990

FORM TP1

APPLICATION FOR PERMISSION TO DEVELOP LAND AND / OR BUILDINGS IN GREATER LONDON

FOR OFFICE USE ONLY

Fee £ 95.00 PP002842
 Cheque / Postal Order / Cash 001645
 Receipt No. Issued 025236

Borough Ref. **COMPLETE**
 Registered No.
 Date Received 11 DEC 2000

PLEASE READ CAREFULLY THE GENERAL NOTES BEFORE FILLING IN THE FORM

PART ONE	To be completed by or on behalf of all applicants as far as applicable
FEE (where applicable)	£ <u>95</u>

1. APPLICANT (in block capitals)
 Name MIR Q DRESSMAN
 Address 7 THE LITTLE BOLTONS
SW10
 Tel. No.

AGENT (if any) to whom correspondence should be sent
 Name JERRY W GEORGE & ASSOCIATES
 Address 17 SUFFSBURY AVENUE
LONDON
W1V 7RL
 Tel. No. 7494 4484 Ref.

2. PARTICULARS OF PROPOSAL FOR WHICH PERMISSION IS SOUGHT

(a) Full address or location of the land to which this application applies
7 THE LITTLE BOLTONS
SW10

(b) Site area

(c) Give details of proposal indicating the purpose for which the land/buildings are to be used and including any change(s) of use.
NEW DORMER WINDOW TO
REAR ROOF SLOPE

(d) State whether applicant owns or controls any adjoining land and if so, give its location.
NO.

(e) State whether the proposal involves:- State Yes or No

(i) New building(s) or extension(s) to existing building(s) NO YES
 If "Yes" state gross floor area of proposed building(s). m²

RECEIVED BY PLANNING SERVICES

EX DIR	HDC	N	C	SV	SE	ENF	AO ACK
--------	-----	---	---	----	----	-----	--------

11 DEC 2000 TP

If residential development state number of dwelling units proposed and type if known, e.g. houses, bungalows, flats.

(ii) Alterations YES NO

(iii) Change of use YES NO
 If "Yes" state gross area of land or building(s) affected by proposed change of use (if more than one use involved state gross area of each use). Hectares/m²

(iv) Construction of new access to a highway } vehicular
 } pedestrian

(v) Alteration of an existing access to a highway } vehicular
 } pedestrian

Strike out whichever is inapplicable

3. PARTICULARS OF APPLICATION

PP002842

State whether this application is for: State Yes or No

(i) Outline planning permission

If "Yes" strike out any of the following which are not to be determined at this stage.

- 1. Siting
- 2. Design
- 3. Landscaping
- 4. External appearance
- 5. Means of access

(ii) Full planning permission YES

(iii) Renewal of temporary permission or permission for retention of building or continuance of use without complying with a condition subject to which planning permission has been granted.

If "Yes" state the date and number of previous permission and identify the previous condition.

Date Number

The Condition

(iv) Consideration under Section 72 only (Industry)

4. PARTICULARS OF PRESENT AND PREVIOUS USE OF BUILDINGS OR LAND

State :-

(i) Present use of buildings/land RESIDENTIAL

(ii) If vacant the last previous use and period of use with relevant dates.

5. LIST ALL DRAWINGS, CERTIFICATES, DOCUMENTS, ETC; forming part of this application

1006/E01, 1006/P01.

6. ADDITIONAL INFORMATION State Yes or No

(a) Is the application for non-residential development NO If "Yes" complete PART THREE of this form (See PART THREE for exemptions)

(b) Does the application include the winning and working of minerals NO If "Yes" complete PART FOUR of this form

(c) Does the proposed development involve the felling of any trees NO If "Yes" state numbers and indicate precise position on plan

(d) (i) How will surface water be disposed of? EXISTING

(ii) How will foul sewage be dealt with? EXISTING.

(e) Materials - Give details (unless the application is for outline permission) of the colour and type of materials to be used for:

(i) Walls N/A

(ii) Roof N/A.

(iii) Means of enclosure TIMBER / LEAD

We hereby apply for (strike out whichever is inapplicable)

(a) Planning permission to carry out the development described in this application and the accompanying plans in accordance therewith

~~(b) Planning permission to retain the building(s) or work(s) already constructed or carried out, or a use of the land already instituted as described in this application and accompanying plans.~~

Signed [Signature] on behalf of MR Q DEGBMAN Date 6/12/2000

AN APPROPRIATE CERTIFICATE MUST ACCOMPANY THIS APPLICATION (See General Notes)

If you are the ONLY owner of ALL the land at the beginning of the period 20 day before the date of application, complete Certificate A. If otherwise see PART TWO of this form.

CERTIFICATE A - Certificate under Section 66 of the Town & Country Planning Act 1990. I hereby certify that:-

*Strike out whichever is inapplicable.

1. No person other than the applicant was an owner (a) of any part of the land to which the application relates at the beginning of the period of 20 days before the date of the accompanying application.

2. None of the land to which the application relates constitutes or forms part of an agricultural holding; or

~~3. *I have / the applicant has given requisite notice to every person other than *myself/himself who, 20 days before the date of the application was a tenant of any agricultural holding any part of which was comprised in the land to which the application relates, viz:-~~

(a) "Owner" means a person having freehold interest or a leasehold interest the unexpired term of which was not less than 7 years.

Name and Address of Tenant

Date of Service of Notice

Signed [Signature] on behalf of MR Q DEGBMAN Date 6/12/2000

TOWN & COUNTRY PLANNING ACT 1990

FORM TP1

APPLICATION FOR PERMISSION TO DEVELOP LAND AND / OR BUILDINGS IN GREATER LONDON

FOR OFFICE USE ONLY

Borough Ref.

Fee £ PPO02842 Registered No.

Cheque / Postal Order / Cash Date Received

Receipt No. Issued

PLEASE READ CAREFULLY THE GENERAL NOTES BEFORE FILLING IN THE FORM

PART ONE	To be completed by or on behalf of all applicants as far as applicable	
	FEE (where applicable)	£ 95

1. APPLICANT (in block capitals)

AGENT (if any) to whom correspondence should be sent

Name MR A DREGBAN
 Address 7 THE LITTLE BOLTONS
SW10
 Tel. No.

Name JERRY W GEORGE & ASSOCIATES
 Address 17 SHIFFSBURY AVENUE
LONDON
W1V 7RL
 Tel. No. 7494 4484 Ref.

2. PARTICULARS OF PROPOSAL FOR WHICH PERMISSION IS SOUGHT

(a) Full address or location of the land to which this application applies
7 THE LITTLE BOLTONS
SW10

(b) Site area

(c) Give details of proposal indicating the purpose for which the land/buildings are to be used and including any change(s) of use.
NEW DORMER WINDOW TO
REAR ROOF SLOPE

(d) State whether applicant owns or controls any adjoining land and if so, give its location.
NO.

(e) State whether the proposal involves:- State Yes or No

(i) New building(s) or extension(s) to existing building(s) NO YES **If "Yes" state gross floor area of proposed building(s).** m²

RECEIVED BY PLANNING SERVICES

EX DIR	HDC	N	C	SW	SE	ENF	AO ACK
--------	-----	---	---	----	----	-----	--------

11 DEC 2000

If residential development state number of dwelling units proposed and type if known, e.g. houses, bungalows, flats.

(ii) Alterations YES NO

APPEALS	IO	REC	ARB	FWD PLN	CON DES	FEE
---------	----	-----	-----	---------	---------	-----

(iii) Change of use YES NO **If "Yes" state gross area of land or building(s) affected by proposed change of use (if more than one use involved state gross area of each use).** Hectares/m²

(iv) Construction of new access to a highway } vehicular
 } pedestrian

(v) Alteration of an existing access to a highway } vehicular
 } pedestrian

Strike out whichever is inapplicable

3. PARTICULARS OF APPLICATION

- State whether this application is for: State Yes or No
- (I) Outline planning permission
- (II) Full planning permission YES
- (III) Renewal of temporary permission or permission for retention of building or continuance of use without complying with a condition subject to which planning permission has been granted.
- (IV) Consideration under Section 72 only (Industry)

If "Yes" strike out any of the following which are not to be determined at this stage.

- 1. Siting
- 2. Design
- 3. Landscaping
- 4. External appearance
- 5. Means of access

If "Yes" state the date and number of previous permission and identify the previous condition.

Date Number

The Condition

.....

.....

4. PARTICULARS OF PRESENT AND PREVIOUS USE OF BUILDINGS OR LAND

State :-

- (I) Present use of buildings/land RESIDENTIAL
- (II) If vacant the last previous use and period of use with relevant dates.

5. LIST ALL DRAWINGS, CERTIFICATES, DOCUMENTS, ETC; forming part of this application

..... 1006/E01 , 1006/P01.

6. ADDITIONAL INFORMATION State Yes or No

- (a) Is the application for non-residential development NO If "Yes" complete PART THREE of this form (See PART THREE for exemptions)
- (b) Does the application include the winning and working of minerals NO If "Yes" complete PART FOUR of this form
- (c) Does the proposed development involve the felling of any trees NO If "Yes" state numbers and indicate precise position on plan
- (d) (I) How will surface water be disposed of? EXISTING
- (II) How will foul sewage be dealt with? EXISTING.
- (e) Materials - Give details (unless the application is for outline permission) of the colour and type of materials to be used for:
 - (I) Walls N/A
 - (II) Roof N/A.
 - (III) Means of enclosure TIMBER / LEAD

We hereby apply for (strike out whichever is inapplicable)

- (a) Planning permission to carry out the development described in this application and the accompanying plans in accordance therewith
- ~~(b)~~ Planning permission to retain the building(s) or work(s) already constructed or carried out, or a use of the land already instituted as described in this application and accompanying plans.

Signed on behalf of MR Q DREGBAN Date 6/2/2000

AN APPROPRIATE CERTIFICATE MUST ACCOMPANY THIS APPLICATION (See General Notes)

If you are the ONLY owner of ALL the land at the beginning of the period 20 day before the date of application, complete Certificate A. If otherwise see PART TWO of this form.

CERTIFICATE A - Certificate under Section 66 of the Town & Country Planning Act 1990. I hereby certify that:-

- *Strike out whichever is unapplicable.
 - 1. No person other than the applicant was an owner (a) of any part of the land to which the application relates at the beginning of the period of 20 days before the date of the accompanying application.
 - ~~2.~~ None of the land to which the application relates constitutes or forms part of an agricultural holding; or *I have / the applicant has given requisite notice to every person other than *myself/himself who, 20 days before the date of the application was a tenant of any agricultural holding any part of which was comprised in the land to which the application relates, viz:-

Name and Address of Tenant

Date of Service of Notice

Signed on behalf of MR Q DREGBAN Date 6/2/2000

PP002842

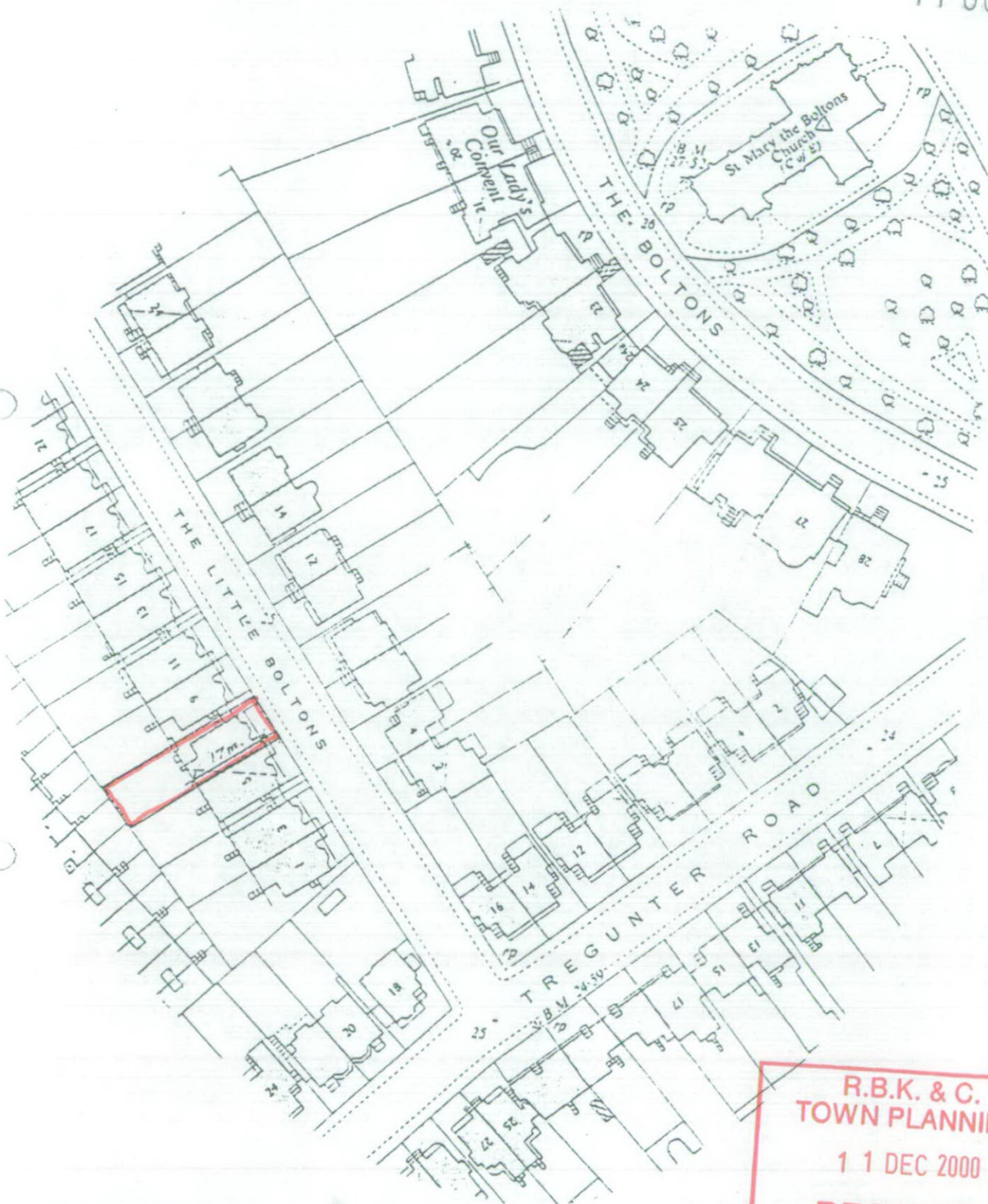

R.B.K. & C.
TOWN PLANNING
11 DEC 2000
RECEIVED

SITE PLAN

scale 1:1250

Wintersgill & Faulkner

17 Shaftesbury Avenue, Piccadilly Circus, London W1V 7RL

Telephone: 0171 734 8671 Fax: 0171 227 071

TOWN & COUNTRY PLANNING ACT 1990

FORM TP1

APPLICATION FOR PERMISSION TO DEVELOP LAND AND / OR BUILDINGS IN GREATER LONDON

FOR OFFICE USE ONLY

Borough Ref.

Fee £

Registered No.

Cheque / Postal Order / Cash

PP002842

Date Received

Receipt No. Issued

PLEASE READ CAREFULLY THE GENERAL NOTES BEFORE FILLING IN THE FORM

PART ONE	To be completed by or on behalf of all applicants as far as applicable	
	FEE (where applicable)	£ 95

1. APPLICANT (in block capitals)

AGENT (if any) to whom correspondence should be sent

Name M R Q DRIGSBAN
 Address 7 THE LITTLE BOLTONS
SW10
 Tel. No.

Name JERRY W GEORGE & ASSOCIATES
 Address 17 SUDBURY AVENUE
LONDON
W1V 7RL
 Tel. No. 7494 4484 Ref.

2. PARTICULARS OF PROPOSAL FOR WHICH PERMISSION IS SOUGHT

(a) Full address or location of the land to which this application applies
7 THE LITTLE BOLTONS
SW10

(b) Site area

(c) Give details of proposal indicating the purpose for which the land/buildings are to be used and including any change(s) of use.
NEW DORMER WINDOW TO
REAR ROOF SLOPE

(d) State whether applicant owns or controls any adjoining land and if so, give its location.
NO.

(e) State whether the proposal involves:- State Yes or No

(i) New building(s) or extension(s) to existing building(s) NO YES **▶** If "Yes" state gross floor area of proposed building(s). **▼** m²

RECEIVED BY PLANNING SERVICES

EX DIR	HDC	N	C	SW	SE	ENF	AO ACK
11 DEC 2000							

If residential development state number of dwelling units proposed and type if known, e.g. houses, bungalows, flats.

(ii) Alterations

APPEALS	IO	REC	ARB	FWD	CON	FEES	703
				PLN	DES		

(iii) Change of use **▶** If "Yes" state gross area of land or building(s) affected by proposed change of use (if more than one use involved state gross area of each use). Hectares/m²

(iv) Construction of new access to a highway } vehicular
 } pedestrian

(v) Alteration of an existing access to a highway } vehicular
 } pedestrian

Strike out whichever is inapplicable

3. PARTICULARS OF APPLICATION

PP002842

State whether this application is for: State Yes or No

(I) Outline planning permission

(II) Full planning permission

(III) Renewal of temporary permission or permission for retention of building or continuance of use without complying with a condition subject to which planning permission has been granted.

(IV) Consideration under Section 72 only (Industry)

If "Yes" strike out any of the following which are not to be determined at this stage.

- 1. Siting 2. Design 3. Landscaping 4. External appearance 5. Means of access

If "Yes" state the date and number of previous permission and identify the previous condition.

Date Number

The Condition

4. PARTICULARS OF PRESENT AND PREVIOUS USE OF BUILDINGS OR LAND

State :-

(I) Present use of buildings/land RESIDENTIAL

(II) If vacant the last previous use and period of use with relevant dates.

5. LIST ALL DRAWINGS, CERTIFICATES, DOCUMENTS, ETC; forming part of this application

1006/501, 1006/101.

6. ADDITIONAL INFORMATION State Yes or No

- (a) Is the application for non-residential development? NO
(b) Does the application include the winning and working of minerals? NO
(c) Does the proposed development involve the felling of any trees? NO

(d) (I) How will surface water be disposed of? EXISTING
(II) How will foul sewage be dealt with? EXISTING.

(e) Materials - Give details (unless the application is for outline permission) of the colour and type of materials to be used for:
(I) Walls N/A
(II) Roof N/A
(III) Means of enclosure TIMBER / GLD

We hereby apply for (strike out whichever is inapplicable)
(a) Planning permission to carry out the development described in this application and the accompanying plans in accordance therewith
(b) Planning permission to retain the building(s) or work(s) already constructed or carried out, or a use of the land already instituted as described in this application and accompanying plans.
Signed [Signature] on behalf of MR Q DEGBMAN Date 6/2/2000

AN APPROPRIATE CERTIFICATE MUST ACCOMPANY THIS APPLICATION (See General Notes)

If you are the ONLY owner of ALL the land at the beginning of the period 20 day before the date of application, complete Certificate A. If otherwise see PART TWO of this form.

CERTIFICATE A - Certificate under Section 66 of the Town & Country Planning Act 1990. I hereby certify that:-

- *Strike out whichever is unapplicable.
1. No person other than the applicant was an owner (a) of any part of the land to which the application relates at the beginning of the period of 20 days before the date of the accompanying application.
2. None of the land to which the application relates constitutes or forms part of an agricultural holding; or
3. *I have / the applicant has given requisite notice to every person other than *myself/himself who, 20 days before the date of the application was a tenant of any agricultural holding any part of which was comprised in the land to which the application relates, viz:-

Name and Address of Tenant
Date of Service of Notice

Signed [Signature] on behalf of MR Q DEGBMAN Date 6/2/2000

JEFFERY W GEORGE & ASSOCIATES

PP002842

Department of Planning and Conservation
Royal Borough of Kensington and Chelsea
The Town Hall
Hornton Street
London W8 7NX

HISTORIC BUILDING CONSULTANCY

ARCHITECTURE

SURVEYING

TOWN PLANNING



6 December 2000

Dear Sir/Madam,

Re: 7 The Little Boltons, SW10

On behalf of my client I hereby submit an application for planning permission to construct a dormer window to the rear slope of the above property.

The proposed design is taken from similar existing dormers on nos. 11 and 13 nearby and also follows guidelines in your files. We understand that consent for no.11 was granted by your Council earlier this year.

Four copies of drawings describing the proposals are enclosed incorporating certificate 'A', a site plan and a cheque for £95.

Should you require any additional information or wish a site visit please do not hesitate to let me know.

Yours faithfully

Jeff George

cc. Quinten Dreesman
Tom Ruddy

RECEIVED BY PLANNING SERVICES							
EX DIR	HDC	N	C	SW	SE	ENF	AO ACK
11 DEC 2000							
APPEALS	IO	REC	ARB	FWD PLN	CON DES	FEES	

17 Shaftesbury Avenue London W1V 7RL
Tel 020 7494 4484 Fax 020 7287 0712
The Old Vicarage Stowe Shropshire LD7 1NB
Tel/Fax 01547 528409
mobile 0831 509561
e-mail jeff@jwga.co.uk