

LBC.

LB002800

Part 1

R.B.K.C. TOWN PLANNING  
APPLICATION  
COMPLETE

TP.1 (H.B./CA)  
Part 1

- 4 DEC 2000

**PLANNING (LISTED BUILDINGS & CONSERVATION AREAS) ACT, 1990**  
**APPLICATION FOR LISTED BUILDING CONSENT / CONSERVATION AREA CONSENT**

1. Name and Address of applicant (i.e. developer) (IN BLOCK LETTERS)

Name MR & MRS. P. McDANELL

Address 40 LABROCK GROVE

KENKINGTON W.11 2AR

Applicant's Telephone No. 020 7221 7785

(if applicable)

Name and Address of applicant's agent to whom notices or other documents in respect of this application should be sent COLIN WHITE FRICS THE HOGARTH GROUP, AIREDALE AVENUE, W4 2NW.

Agent's telephone No. 0208 994 0929

**WE** hereby apply for consent to carry out the works described in this application and on the attached plans and drawings.

Signed Colin White FRICS on behalf of Mr & Mrs P. McDanell Date 24.11.2000

2. Full address or location of the land to which application relates 40 LABROCK GROVE, W11 2AR

3. (a) Brief particulars of the proposed works. (a) A new conservatory situated in the rear garden and connected to the Gnd Floor and Basement maisonette by a fully glazed external corridor.  
(b) State what the proposal involves (i) Demolition of the building(s)  
(Delete the items which do not apply) (ii) Alterations and/or Extensions

4. State the purpose for which the land is  
(a) now used, or (a) Rear Garden LB002800  
(b) if vacant, the last known use (b) -  
(c) proposed to be used (c) ditto but with conservatory.

5. State (a) suitable location on building or within curtilage of building for display of statutory notice in respect of this application; and (b) name and address of person to whom application should be made for facilities to display notice.  
(a) Adjacent to the rear gate from the rear garden to the adjoining shared gardens.  
(b) Mrs. P. McDanell at 40 Labrock Grove W11. 2AR

6. List of drawings and plans submitted with the application. (See Notes).  
LG 101 SITE PLAN  
LG 102 PLAN & ELEVATIONS

**CERTIFICATE UNDER SECTION 11, PART I OF THE PLANNING (LISTED BUILDINGS & CONSERVATION AREAS) ACT, 1990**

**CERTIFICATE A (See Notes).**

I hereby certify that no person other than myself/the applicant\* was an owner of the building to which the application relates at the beginning of the period of 20 days before the date of the accompanying application.

Signed Colin White FRICS on behalf of Mr & Mrs P. McDANELL Date 24/11/2000

\*Delete where appropriate

STRIKE THROUGH THE CERTIFICATES WHICH DO NOT APPLY AND SIGN AT THE FOOT OF THE PAGE

# PLANNING (LISTED BUILDINGS & CONSERVATION AREAS) ACT, 1990

## CERTIFICATE UNDER SECTION 11, PART 1

### CERTIFICATE B I hereby certify that

I have/the applicant\* has given requisite notice to all the persons other than myself/the applicant\* who, 20 days before the date of the accompanying application, were owners (a) of the building to which the application relates

Name of Owner ..... Address .....  
..... Date of Service of Notice .....

### CERTIFICATE C I hereby certify that

1. I am/the applicant is unable to issue a certificate in accordance with either sub-paragraph (a) or sub-paragraph (b) of Section 11 Part 1 of the Planning (listed building and Conservation Areas) Act, 1990, in respect of the application dated .....

2. I have/the applicant has\* given the requisite notice to the following persons other than myself who, 20 days before the date of application were owners (a) of the building to which the application relates, viz.

Name of Owner ..... Address .....  
..... Date of Service of Notice .....

3. I have/the applicant has\* taken the steps listed below, being steps reasonably open to me/him\*, to ascertain the names and addresses of the other owners (a) of the building and have/has\* been unable to do so.

(b) .....  
.....  
.....

4. Notice of the application as set out below has been published in the (c) .....  
..... on (d) .....

### OR CERTIFICATE D I hereby certify that

1. I am/the applicant is\* unable to issue a certificate in accordance with sub-paragraph (a) of Section 11 Part I of the Planning (Listed Buildings and Conservation Areas), Act 1990, in respect of the accompanying application dated ..... and have/has\* taken the steps listed below, being steps reasonably open to me/him\* to ascertain the names and addresses of all the persons other than myself/himself\* who, 20 days before the date of the application were owners (a) of the building to which the application relates and have/has\* been unable to do so:

(b) .....  
.....

2. Notice of the application as set out below has been published in the (c) .....  
..... on (d) .....

Signed ..... \*On behalf of ..... Date .....

- NOTES**
- (a) Owner means a person having freehold interest or leasehold interest the unexpired term of which was not less than 7 years.
  - (b) Insert description of steps taken.
  - (c) Insert name of local newspaper circulating in the locality in which the land is situated.
  - (d) Insert date of publication (which must not be earlier than 20 days before the application).

\*Delete where appropriate

LBC.

LB002800

Part 1

**A.B.K.C. TOWN PLANNING APPLICATION COMPLETE**

- 4 DEC 2000

T.P.1 (H.B./CA) Part 1

**PLANNING (LISTED BUILDINGS & CONSERVATION AREAS) ACT, 1990**  
**APPLICATION FOR LISTED BUILDING CONSENT/ CONSERVATION AREA CONSENT**

1. Name and Address of applicant (i.e. developer) (IN BLOCK LETTERS)

Name MR & MRS. P. McDANELL  
Address 40, LABBROKE GROVE  
KENSINGTON W.11 2AR  
Applicant's Telephone No. 020 7221 7785

(If applicable)

Name and Address of applicant's agent to whom notices or other documents in respect of this application should be sent COLIN WHITE FRICS THE HOGARTH GROUP, AIREDALE AVENUE W4 2NW.  
Agent's telephone No. 0208 994 0929

**I/We** hereby apply for consent to carry out the works described in this application and on the attached plans and drawings.

Signed Colin White FRICS on behalf of Mr & Mrs P. McDanell Date 24.11.2000

2. Full address or location of the land to which application relates 40 LABBROKE GROVE, W11 2AR

3. (a) Brief particulars of the proposed works. (a) A new conservatory situated in the rear garden and connected to the Gnd Floor and Basement mansette by a fully glazed external corridor.  
(b) State what the proposal involves (i) Demolition of the building(s)  
(Delete the items which do not apply) (ii) Alterations and/or Extensions

4. State the purpose for which the land is  
(a) now used, or (a) Rear Garden  
(b) if vacant, the last known use (b) -  
(c) proposed to be used (c) Ditto but with conservatory.

5. State (a) suitable location on building or within curtilage of building for display of statutory notice in respect of this application; and (b) name and address of person to whom application should be made for facilities to display notice.  
(a) Adjacent to the rear gate from the rear garden to the adjoining shared gardens  
(b) Mrs. P. McDanell at 40 Labbroke Grove W11. 2AR

6. List of drawings and plans submitted with the application. (See Notes).  
LG 101 SITE PLAN  
LG 102 PLAN & ELEVATIONS LB002800

**CERTIFICATE UNDER SECTION 11, PART I OF THE PLANNING (LISTED BUILDINGS & CONSERVATION AREAS) ACT, 1990**

**CERTIFICATE A (See Notes).**

I hereby certify that no person other than myself/the applicant\* was an owner of the building to which the application relates at the beginning of the period of 20 days before the date of the accompanying application.

Signed Colin White FRICS on behalf of Mr & Mrs P. McDANELL Date 24/11/2000

\*Delete where appropriate

# PLANNING (LISTED BUILDINGS & CONSERVATION AREAS) ACT, 1990

## CERTIFICATE UNDER SECTION 11, PART 1

### CERTIFICATE B I hereby certify that

I have/the applicant\* has given requisite notice to all the persons other than myself/the applicant\* who, 20 days before the date of the accompanying application, were owners (a) of the building to which the application relates

Name of Owner ..... Address .....  
..... Date of Service of Notice .....

### CERTIFICATE C I hereby certify that

1. I am/the applicant is unable to issue a certificate in accordance with either sub-paragraph (a) or sub-paragraph (b) of Section 11 Part 1 of the Planning (listed building and Conservation Areas) Act, 1990, in respect of the application dated .....

2. I have/the applicant has\* given the requisite notice to the following persons other than myself who, 20 days before the date of application were owners (a) of the building to which the application relates, viz.

Name of Owner ..... Address .....  
..... Date of Service of Notice .....

3. I have/the applicant has\* taken the steps listed below, being steps reasonably open to me/him\*, to ascertain the names and addresses of the other owners (a) of the building and have/has\* been unable to do so.

(b) .....  
.....  
.....

4. Notice of the application as set out below has been published in the (c) .....  
..... on (d) .....

### OR CERTIFICATE D I hereby certify that

1. I am/the applicant is\* unable to issue a certificate in accordance with sub-paragraph (a) of Section 11 Part I of the Planning (Listed Buildings and Conservation Areas), Act 1990, in respect of the accompanying application dated ..... and have/has\* taken the steps listed below, being steps reasonably open to me/him\* to ascertain the names and addresses of all the persons other than myself/himself\* who, 20 days before the date of the application were owners (a) of the building to which the application relates and have/has\* been unable to do so:

(b) .....  
.....  
.....

2. Notice of the application as set out below has been published in the (c) .....  
..... on (d) .....

Signed ..... \*On behalf of ..... Date .....

- NOTES**
- (a) Owner means a person having freehold interest or leasehold interest the unexpired term of which was not less than 7 years.
  - (b) Insert description of steps taken.
  - (c) Insert name of local newspaper circulating in the locality in which the land is situated.
  - (d) Insert date of publication (which must not be earlier than 20 days before the application).

\*Delete where appropriate



PP002799

# NOTTING HILL

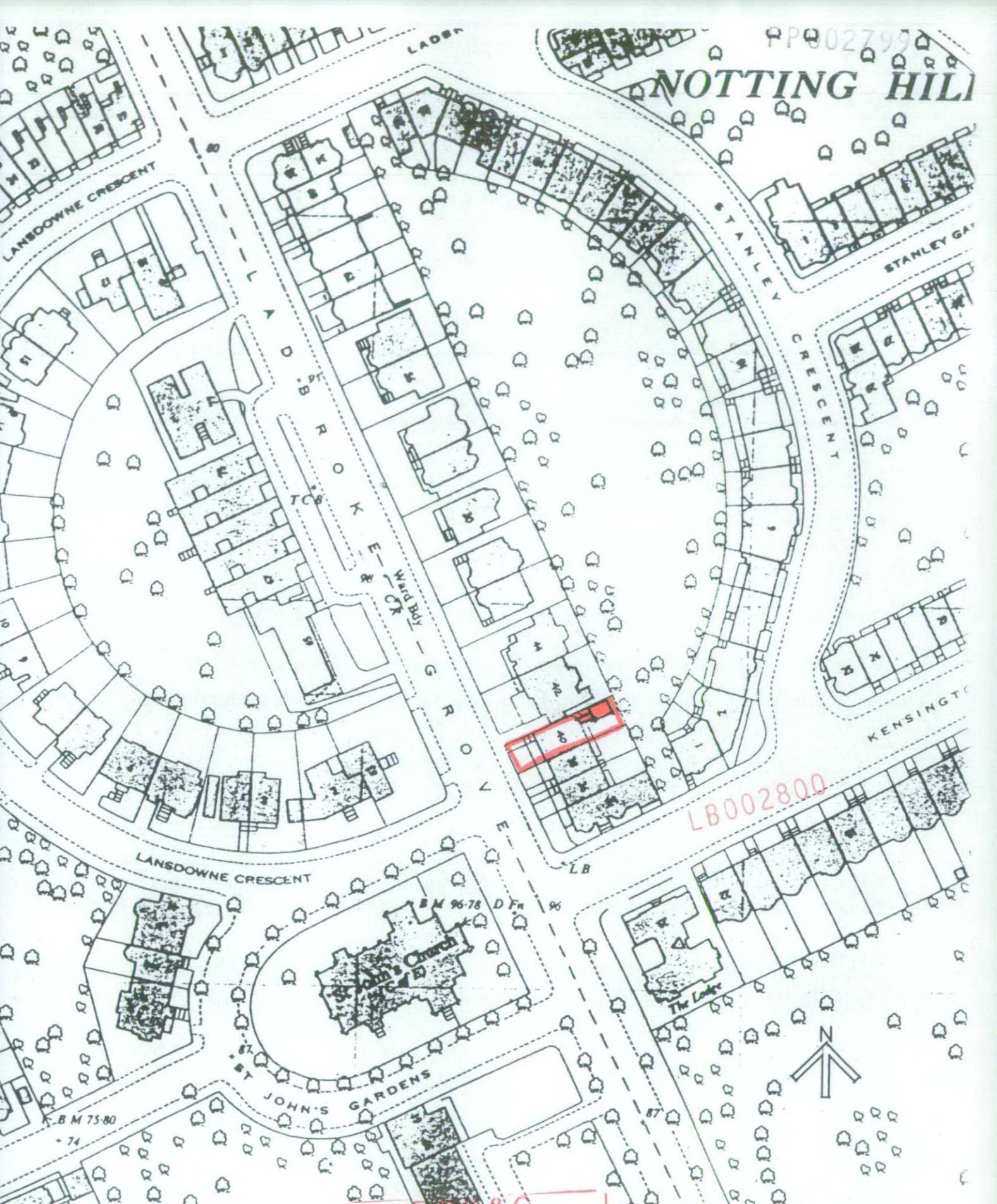

LB002800

R.F. & C.  
**TOWN PLANNING**  
 SITE PLAN 1:1250  
 DWG. NO. LG/ 101  
**RECEIVED**

40 LADBROKE GROVE  
 LONDON W11 2PA

PROPOSED CONSERVATORY  
 TO REAR GARDEN

COLIN WHITE FRICS  
 THE HOGARTH GROUP  
 AIREDALE AVENUE  
 LONDON W4 2NW Oct 2000