

MATERIAL INDICATOR:  
 ASPHALT/PAVEMENT  
 CONCRETE  
 BRICKWORK  
 CERAMIC TILE  
 POLYMER CONCRETE  
 REINFORCED CONCRETE  
 INSULATED CONCRETE  
 BRICKWORK WITH FACE  
 BRICKWORK (NO FIN)  
 STEEL FRAME SYSTEM (NO  
 MW (E. METRE))  
 REINFORCING STEELWORK  
 UNFINISHED  
 DAMAGED AND DETERIORATED  
 LOG OF THE SLAB

FACADE MATERIALS / FINISHES:  
 CONCRETE  
 BRICKWORK  
 CERAMIC TILE  
 POLYMER CONCRETE  
 INSULATED CONCRETE  
 BRICKWORK WITH FACE  
 BRICKWORK (NO FIN)  
 STEEL FRAME SYSTEM (NO  
 MW (E. METRE))  
 REINFORCING STEELWORK  
 UNFINISHED  
 DAMAGED AND DETERIORATED  
 LOG OF THE SLAB

WINDOW NUMBERING SYSTEM:  
 TYPE: WINDOW  
 NUMBER: WINDOW

APPROXIMATE PROPERTY LINE  
 PROPOSED BY THIS  
 OFFICE TO EXISTING  
 MURBURN

APPROXIMATE PROPERTY LINE  
 PROPOSED BY THIS  
 OFFICE TO EXISTING  
 MURBURN

APPROXIMATE PROPERTY LINE  
 PROPOSED BY THIS  
 OFFICE TO EXISTING  
 MURBURN

APPROXIMATE PROPERTY LINE  
 PROPOSED BY THIS  
 OFFICE TO EXISTING  
 MURBURN

APPROXIMATE PROPERTY LINE  
 PROPOSED BY THIS  
 OFFICE TO EXISTING  
 MURBURN

APPROXIMATE PROPERTY LINE  
 PROPOSED BY THIS  
 OFFICE TO EXISTING  
 MURBURN

APPROXIMATE PROPERTY LINE  
 PROPOSED BY THIS  
 OFFICE TO EXISTING  
 MURBURN

APPROXIMATE PROPERTY LINE  
 PROPOSED BY THIS  
 OFFICE TO EXISTING  
 MURBURN

APPROXIMATE PROPERTY LINE  
 PROPOSED BY THIS  
 OFFICE TO EXISTING  
 MURBURN

APPROXIMATE PROPERTY LINE  
 PROPOSED BY THIS  
 OFFICE TO EXISTING  
 MURBURN

APPROXIMATE PROPERTY LINE  
 PROPOSED BY THIS  
 OFFICE TO EXISTING  
 MURBURN

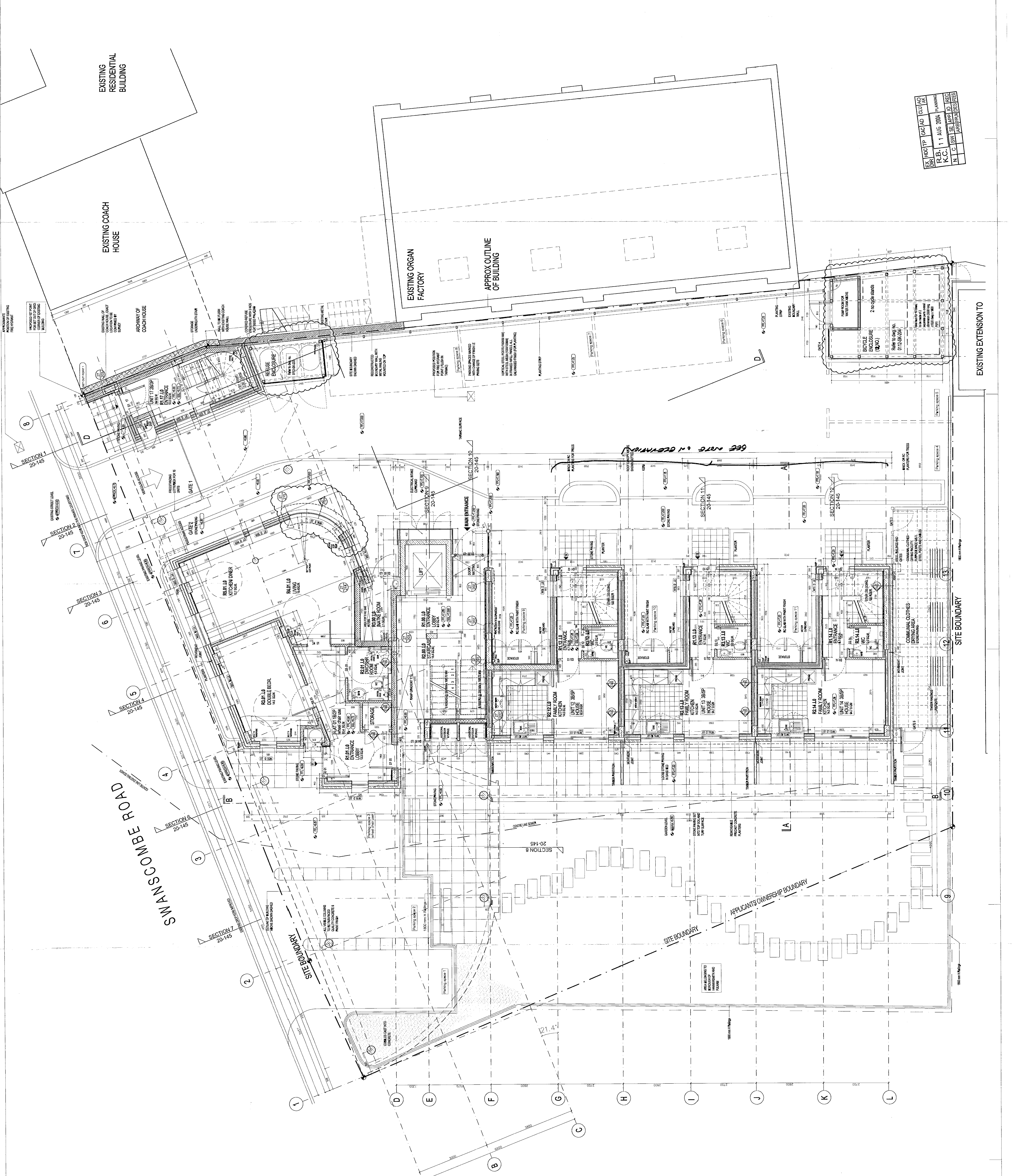

EUGENA

PROJECT: 7 Swanscombe Road, Murburn VIC  
 DRAWING: 25-1-00 CONSTRUCTION  
 DATE: 11 AUG 2008  
 DRAWN BY: [Name]  
 CHECKED BY: [Name]

Drawing number: 0112-20-120  
 Revision: B  
 avanti architects  
 11/11 Market Street, Melbourne VIC 3000  
 Tel: (03) 9412 1111  
 Fax: (03) 9412 1112  
 Email: info@avanti.com.au  
 Website: www.avanti.com.au

R.B. 11 AUG 2008  
 N.C. 20-1-00  
 R.B. 11 AUG 2008  
 N.C. 20-1-00