

**ROYAL BOROUGH  
OF  
KENSINGTON & CHELSEA**

**DOCUMENT SEPARATOR**

**DOCUMENT TYPE:**

**APPROVED DRAWINGS**

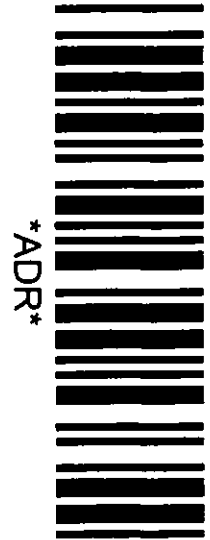

**\*ADR\***

CUSTOMER. SURE START STORAGE CONTAINER  
SUTTON ESTATE.

PPC20693

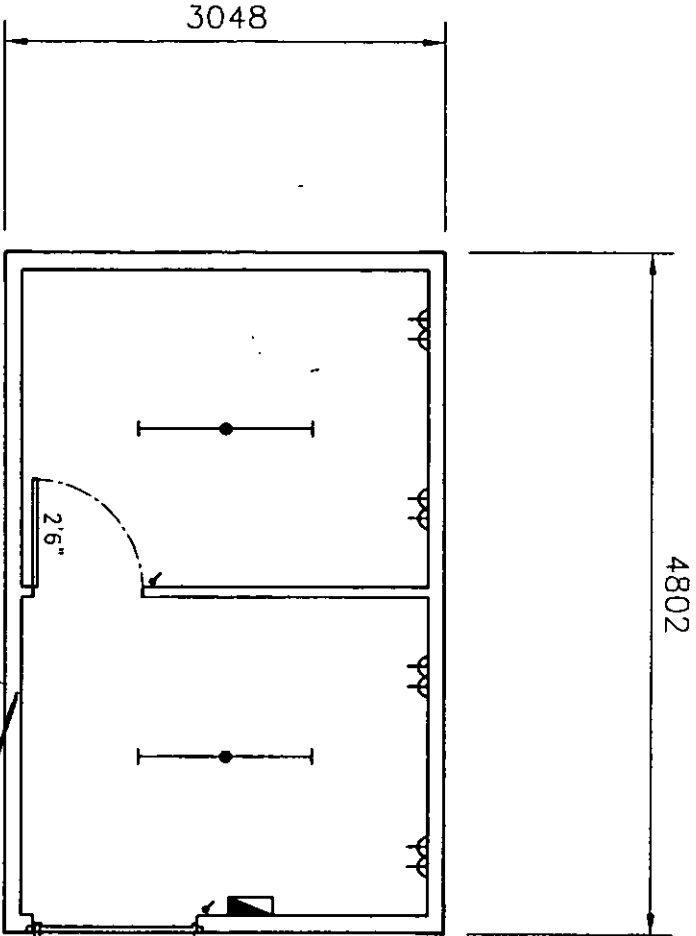

LINED WITH 6mm PLY  
MONO WHITE CEILING PANELS  
'POLYFLOOR' FLOORING  
WOODSTAIN TRIM.

DELEGATED  
APPROVAL  
14 MAY 2002

PERSONNEL DOOR  
TIGHT TO CORNER  
PILLAR.

1200mm WIDE  
90° PERSONNEL  
DOOR c/w TWIN  
LOCK BOXES.

1:1  
1:100  
1:5  
1:50  
1:20  
1:200  
1:1250  
1:2500

KEY TO SYMBOLS

	Consumer Unit
	Twin Sckt., 300mm above F.F.F.
	4' Fluorescent Light
	Light Switch

EX DIR | HDC TP | CAC AD | CLU AD | AK

R.B. | K.C. | 20 MAR 2002 | PLANNING

N | C | SW | SE | PP | IO | REC

ARB | PPLIDES | FEES

APPROVAL BOX

Customer:  
Signature:  
Name:  
Date:

ISSUE	DATE	DESCRIPTION
1	28/02/02	FIRST ISSUE

This document is the property of LYDNEY CONTAINERS Ltd and should not be used or copied without express permission from: LYDNEY CONTAINERS Limited, Harbour Road, Lydney, Gloucestershire, GL15 4EJ

**TITLE** 16'x10' Split Office

8' high - Flat roof

- no windows

LYDNEY CONTAINERS  
01594 842 378

DESIGN	SUB	DATE	28/02/02	DRG. No.	SSS_OP1610V01
APPROVED		DATE			
CHECKED		DATE			

FS

11-1944 JMS  
BIBBICANT  
DIT SCHIED