

Planning and Borough Development
Kensington Town Hall, Hornton Street, LONDON, W8 7NX

Executive Director of Planning and Borough Development
David Prout

Head of Development Control
Derek Taylor

Drivers Jonas LLP
85 King William Street
London
EC4N 7BL



THE ROYAL BOROUGH OF
**KENSINGTON
AND CHELSEA**

27 July 2009

My reference:DPS/DCPIO/History
Your reference:AD/RB/067256
Please ask for: Erin Hooper

Dear Sirs

Re: Planning (Listed Buildings and Conservation Areas) Act 1990
Natural History Museum – Fire Precautions Project

Thank you for your letter dated 10 March 2009 regarding the fire precautions project. I apologise for the delay in responding.

I have considered the details outlined in your letter, the enclosed information from Hallmark Fire Ltd, which is titled 'Fire/voice alarm cabling methodology within the Public and other areas of aesthetic interest and the information on drawing E32239-46 Rev A and E32239-19 Rev B. Based on the information submitted and consultation with Listed Building Officer, Hilary Bell, I am of the opinion that Listed Building Consent is not required.

I trust this is of assistance. Should you require any further assistance please do not hesitate to contact the undersigned.

Yours faithfully

Erin Hooper
Acting Team Leader Public Participation

Direct Line: 02073613012
Fax: 02073613463
Email: erin.hooper@rbkc.gov.uk
Web: www.rbkc.gov.uk

F

Lbc. Not required.

#18

20.03.09



Drivers Jonas LLP
85 King William Street
London
EC4N 7BL
Tel 020 7896 8000
Fax 020 7896 8002
www.driversjonas.com

Our ref AD/RB/067256

Hilary Bell
Senior Conservation Architect
RBKC
The Town Hall
Hornton Street
London
W8 7NX

10 March 2009

Exd	HDC	HSS	HPD	Pol	Des	ARB	Rec
Reg	PIO	11 MAR 2009				RBKC Planning	APP
DC Nth	DC Cen	DC Sth	Obj	Supp	No Obj	Rev	Other
						Cond	FDA

Dear Madam

Natural History Museum - Fire Precautions Project

I write further to the English Heritage and Royal Borough of Kensington and Chelsea (EHRBKC) meeting on 11th December 2008 in relation to the Natural History Museum's proposals to install a new fire/voice alarm system in the Museum.

As discussed, the Museum are seeking to improve and upgrade the existing fire alarm system within the Waterhouse Building by installing new speakers in the public galleries, private areas and basement. The new system will provide a more efficient fire warning and voice alarm system in the busiest galleries within the Museum.

Further to the EHRBKC meeting, detailed designs, photos and specification have been prepared, as requested. The proposals do not involve any external alteration and therefore we do not envisage that Planning Permission is required. In addition, as discussed at the meeting, it is our understanding that Listed Building Consent is not required.

However, as requested, please find enclosed two copies of the proposal details and drawings which set out the proposed works and method statement for your reference. A summary of these proposals are detailed below.

Proposals

As discussed, the Museum is proposing to install a new fire/voice alarm in the galleries and basement of the Waterhouse Building. This is an extension and improvement to the current system.

The proposals include the installation of ceiling mounted smoke and heat detectors and associated alarm speakers which will be mounted to the wall. The speakers will be either cabinet or column form and will be located above head height within the gallery.

The detectors will be mounted to the ceiling via a connection box and a detector base which will be attached via raw plugs and screws. Where a secure fixing is not possible, for example, on crooked ceiling joists, toggle bolts will be used.

The wall speakers will be provided in a matt and neutral finish (RAL 1019 MATT FINISH) to accord with the wall colourings and materials.

In addition, it is proposed that copper wiring will be used to link the speakers which will accord with the chosen speaker colour and existing stone-work. The cabling methodology proposes that the wiring will follow the corners and crevices where possible and that mortar lines will be used for fixing especially in public areas. The new speakers will be fixed to the walls via suitable raw plugs and fixings using the existing mortar joints. It is not envisaged that there will be any alterations or fixings to the existing walls.



Hilary Bell

-2-

10 March 2009

Full details of the proposed cabling can be found in the enclosed methodology. In addition, Drawing E32239 19B shows an indicative plan of the location and positioning of the individual units within one gallery and drawing E32239-46A illustrates the speaker fixing details.

Summary

In summary, the new fire/voice alarm system and speakers will be situated above head height to minimise the visual impact on the existing gallery. The colours of the new speakers and cabling system have been chosen to accord with the existing materials and minimise the impact upon the building. Furthermore, the cabling will use mortar joints for fixings and follow the corners of the stonework to reduce the physical impact upon the existing structure in public areas.

If you have any further queries or require any additional information, please don't hesitate to contact me on the details provided below.

Yours faithfully

Adam Donovan
for **DRIVERS JONAS LLP**

adamdonovan@driversjonas.com
Tel: 0207 896 8263

ENCS

CC: Erin Hooper (RBKC)
Tim Jones (English Heritage)



Hallmark Fire Ltd

www.hallmarkfire.co.uk
Tel: 08700 11 11 50

sales@hallmarkfire.co.uk
Fax: 08700 11 11 60

HEAD OFFICE
Systems House
Stoke Road
Hoo, Rochester
Kent ME3 9NT

Fire Detection, Suppression & Voice Communication Specialists

Fire/ voice alarm cabling methodology within the Public and other areas of aesthetic interest

Hallmark Fire propose to install the wiring in the corners and crevices of the ornate stonework following symmetrical outlines where possible, the mortar lines will be used or cable fixing and cable routes to devices (see arrow indicator).

The Fire /Voice Alarm cabling types used within these areas will generally be as described within the following extract from the tender specification:

"The fire alarm wiring shall be in Mineral Insulated Copper Cable (MICC) with a minimum CSA of 1.5mm² generally with red LSF sheath unless for aesthetic reasons either white sheathed or bare MICC cabling shall be utilized. The Contractor shall provide a schedule or shall clearly show on design drawings the cabling system to be utilized in each area for approval however it is expected that the Contractor will have a general understanding of the Clients requirements. **The use of soft skinned fire retardant cable may only be permitted with written permission/approval from the PM and design team.**"

An approximation of a typical fixture is shown below-



Wall speaker shown in standard finish



Wall speaker colour requested (RAL 1019) matt finish)

Full National Coverage



LPS 1014 & LPS1204 Certificated
Fire Detection and Alarm and Fixed
System Firm. Certificate Nos.
CFA 140 & CFSI-010



Assessed to ISO 9001:2000
Certificate No. 452



SP201 & SP202 Certificated
Fire Detection & Alarm &
Fixed Fire Fighting Firm



constructionline
UK'S LEADING INDEPENDENT QUALITY ASSURANCE



Link-up





Exd	HDC	HSS	HPD	Poi	Des	ARB	Rec
Reg	PIO	11 MAR 2009				RBKC Planning	APP
DC Nth	DC Cen	DC Sth	Obj	Supp	No Obj	Rev Cond	Other PCA

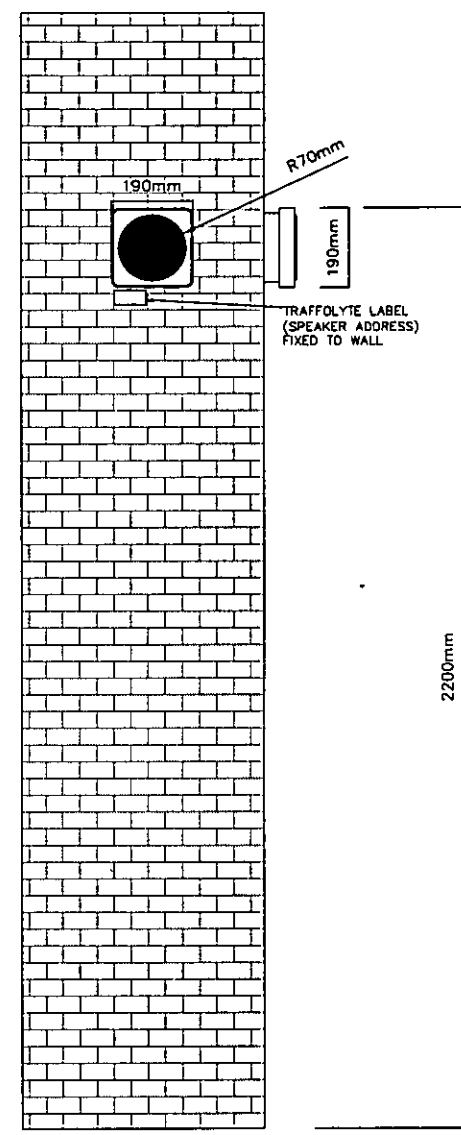

SENTRY
6/STC
METAL
CABINET
SPEAKER
(TYPE A)

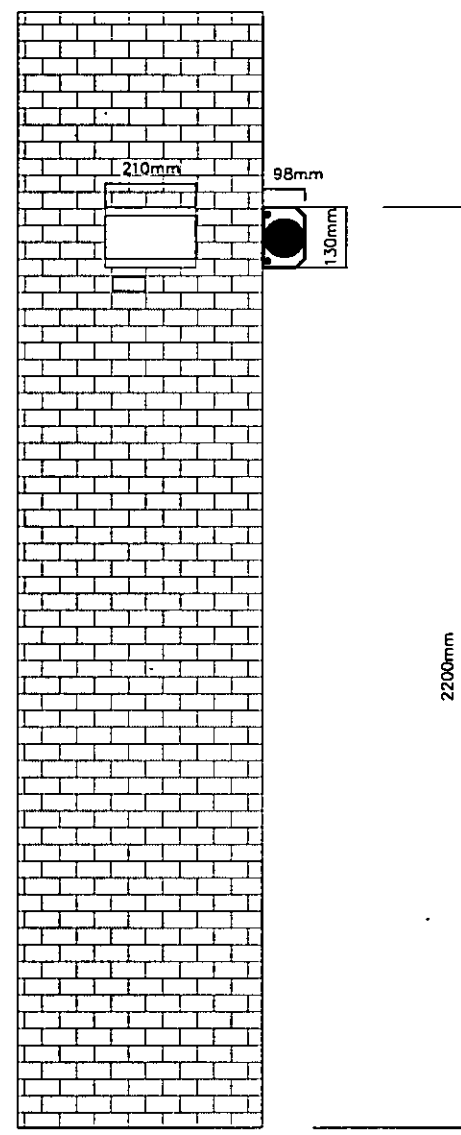

SENTRY
6/BDTC
BI-DIRECTIONAL
SPEAKER
(TYPE B)

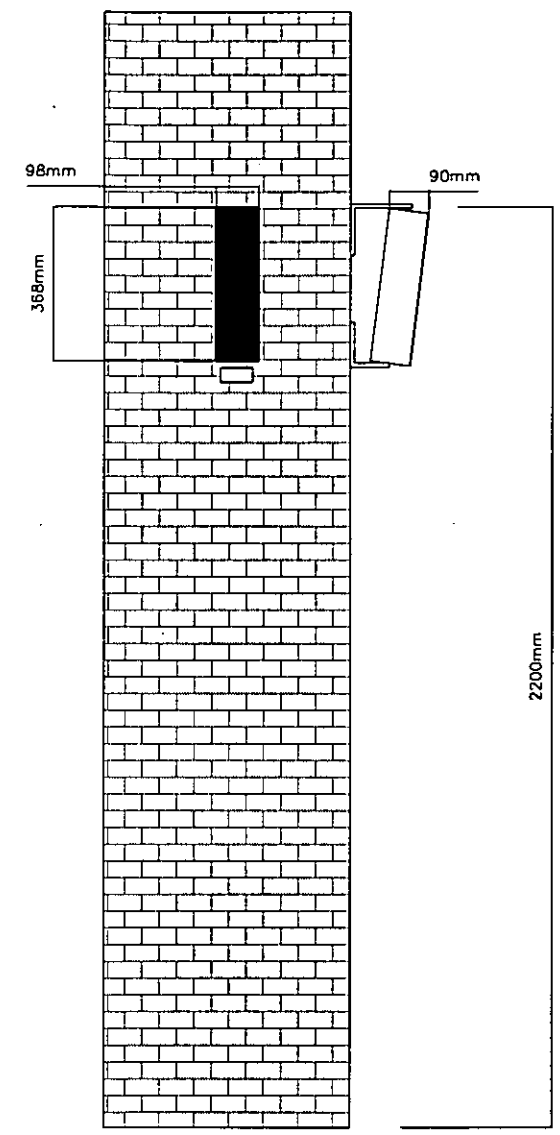

MCS 20/TC
METAL
COLUMN
SPEAKER
(TYPE D)

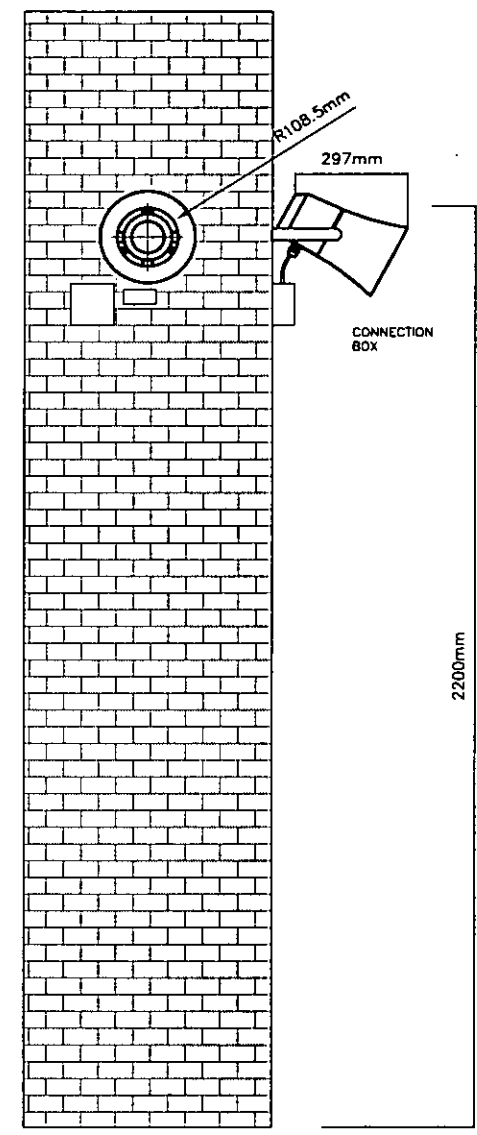

HORN
SPEAKER
(TYPE G)

LEGEND

NOTES

ISSUED FOR APPROVAL

Rev	Date	Description
Project Title		
NATURAL HISTORY MUSEUM CROMWELL ROAD, LONDON		
Drawing Title		
VOICE ALARM SPEAKERS TYPICAL FIXING DETAILS		
Drawn	WC	Scale 1:100 @ AO
Checked		Approved
Hallmark Fire Limited Fire Protection and the Associated Services HEAD OFFICE System House, Snake Road, 16th, Knebworth, Kent ME3 9NT TELEPHONE: 08700 11 11 50 FACSIMILE: 08700 11 11 60 E-MAIL: sales@hallmarkfire.co.uk WEBSITE: www.hallmarkfire.co.uk		
Project Ref.	E32239	Revision
CAD Ref.	E32239-48	A
© Copyright Hallmark Fire Limited		

Ext	HOC	HSS	HPD	Pol	Des	ANB	Rec
Reg	PIO	11 MAR 2009			RBKC	Planning	
DC	DC	DC	Obj	Supp	No Obj	Rev	Other
hth	Gen	8th				Conc	FLA

- LEGEND
- OPTICAL SMOKE DETECTOR
 - HEAT DETECTOR
 - MULTI-SENSOR FIRE DETECTOR
 - LED REMOTE INDICATOR
 - MANUAL BREAK GLASS CALL POINT
 - BEAM DETECTOR SET
 - REFLECTOR
 - MAGNETIC DOOR HOLD OPEN
 - VOICE ALARM CABINET SPEAKER (TYPE A)
 - VOICE ALARM BI-DIRECTIONAL CABINET SPEAKER (TYPE B)
 - VOICE ALARM CEILING SPEAKER (TYPE C)
 - VOICE ALARM COLUMN SPEAKER (TYPE D)
 - VOICE ALARM HORN SPEAKER (TYPE E)
 - VISUAL BEACON
 - BEACON IN CEILING VOID
 - ▨ AREA EXCLUDED FROM WORKS
 - ▭ AREA INCLUDES IN WORKS

- NOTES
1. REFERENCE DWG- NMM/2176/PA3/118
 2. SMOKE DETECTORS MAY BE INSTALLED CLOSER TO OBSTRUCTIONS THAN RECOMMENDED WITHIN BS5839 PART 1 TYPE L1 2008

ISSUED FOR APPROVAL

Rev	Date	Description
8	03/02/09	SPEAKER DETAIL ADDED
4	22/01/09	FIRE ISSUE

Project Title
NATURAL HISTORY MUSEUM
CROWELL ROAD, LONDON

Drawing Title
WATERHOUSE FIRST FLOOR EAST
FIRE ALARM LAYOUT

Drawn	MF	Scale	1:100	AD
Checked		Approved		

Hallmark Fire Limited
The Detection and Gas Detection Specialists
HEAD OFFICE
Systems House, Shake Road,
New, Rochester, Kent ME3 9NT
TELEPHONE: 08700 11 11 50
FACSIMILE: 08700 11 11 40
E-MAIL: sales@hallmarkfire.co.uk
WEBSITE: www.hallmarkfire.co.uk

Project Ref.	E32239	Revision	
CAD Ref.	E32239-19		B

© Copyright Hallmark Fire Limited

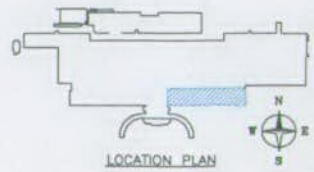
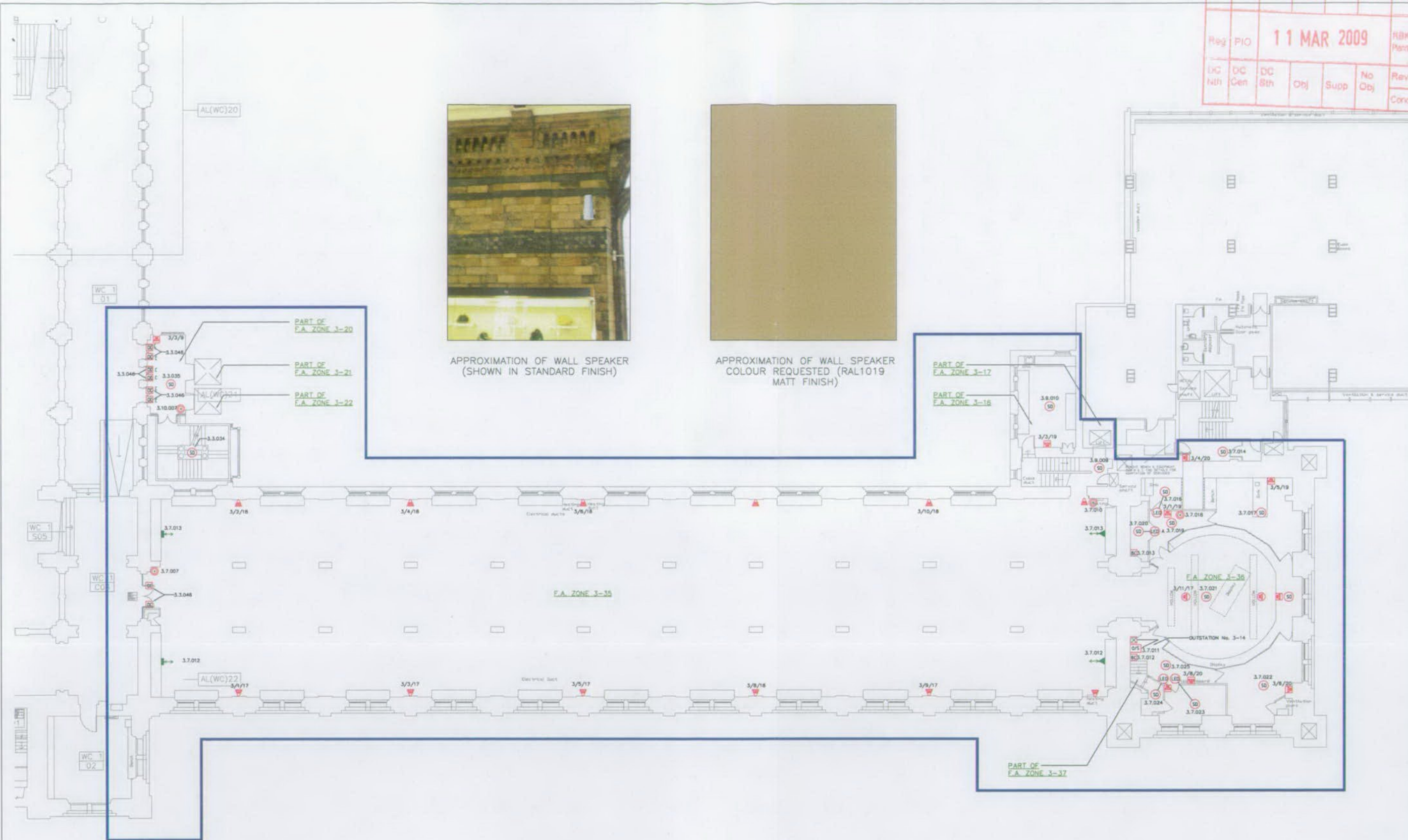



Planning and Borough Development
Kensington Town Hall, Hornton Street, LONDON, W8 7NX

Executive Director of Planning and Borough Development
David Prout

Head of Development Control
Derek Taylor

Drivers Jonas LLP
85 King William Street
London
EC4N 7BL



THE ROYAL BOROUGH OF
**KENSINGTON
AND CHELSEA**

27 July 2009

My reference:
Your reference:
Please ask for: Erin Hooper

Dear Sirs

**Re: Planning (Listed Buildings and Conservation Areas) Act 1990
Natural History Museum – Staff Showers Refurbishment**

Thank you for your letter dated 04 March 2009 regarding the refurbishment of the staff showers. I apologise for the delay in responding.

In your letter you have detailed the particulars of the refurbishment and maintenance works proposed. Based on the description provided in your letter and consultation with Listed Building Officer, Hilary Bell, I am of the opinion that Listed Building Consent is not required.

I trust this is of assistance. Should you require any further assistance please do not hesitate to contact the undersigned.

Yours faithfully

Erin Hooper
Acting Team Leader Public Participation

Direct Line: 02073613012
Fax: 02073613463
Email: erin.hooper@rbkc.gov.uk
Web: www.rbkc.gov.uk

F

Exd	HDC	HSS	H-PD	Foi	Yes	ARB	Rec
Reg	PIO	05 MAR 2009				RBKC Planning	APP
DC Nth	DC Cen	DC Stn	Obj	Supp	No Obj	Rev	Other
						Cond	PDA

LBC - Not required.
HIS 20.03.09

3



Drivers Jonas LLP
85 King William Street
London
EC4N 7BL
Tel 020 7896 8000
Fax 020 7896 8002
www.driversjonas.com

Hilary Bell
Senior Conservation Architect
Conservation and Design
Royal Borough of Kensington and Chelsea
The Town Hall
Hornton Street
London
W8 7NX

Our ref AD/RB/067256

04 March 2009

Dear Sir/Madam

Natural History Museum - Staff Showers Refurbishment

I write further to our recent email correspondence in relation to the Natural History Museum's proposals to refurbish and carry out maintenance works to the basement staff toilets and showers.

As discussed, as no external alterations are proposed we do not envisage that Planning Permission is necessary. However, we would be grateful if you could confirm whether Listed Building Consent is required.

As requested, please find enclosed two paper copies of the Staff Showers Refurbishment tender document produced by the Museum which sets out the details of the proposed works. A summary of these proposals are detailed below.

Proposals

The Museum is proposing to refurbish and carry out maintenance works to the staff toilets and showers which are located in the basement of the Waterhouse Building. The facilities are for the sole use of the Museum's staff and are not accessible to the public.

Currently, these existing facilities are considerably dated and in a poor state of repair and to this extent do not meet the Museum's requirements.

On this basis, the following works are proposed to improve and enhance these facilities::

- Replacement of existing suspended ceilings;
- Re-organisation of space through the removal of partition walls;
- New flooring finish including waterproof underlay and linoleum floor finish;
- Replacement and relocation of wash hand basins and new urinal;
- Improved ventilation through new fan extract system;
- Installation of new showers;
- Installation of a new water tank or boiler; and
- Two new low level radiators to replace existing radiator.



Hilary Bell

-2-

04 March 2009

Summary

In summary, the above proposals comprise internal alterations only which will not require any significant demolition or alteration to the existing fabric of the building.

The alterations are minor in nature and seek to refurbish and improve the existing facilities. In addition, the proposed works do not seek to alter any historic features, fixtures or fittings of the building.

On this basis, as these works do not propose material alterations to the fabric of the building, we do not consider that Listed Building Consent will be required.

Therefore, further to our previous email correspondence I would be grateful if you could formally confirm that Listed Building Consent will not be required for these works.

Please call me if you wish to discuss or require any additional information.

Yours faithfully

A handwritten signature in black ink, appearing to read "Adam Donovan".

Adam Donovan
for DRIVERS JONAS LLP

adamdonovan@driversjonas.com
Tel: 0207 896 8263

ENCS.

CC.	E Hooper	Royal Borough of Kensington and Chelsea
	K Rellis	Natural History Museum
	L Kiragu	Natural History Museum