

© Penoyre & Prasad LLP
For planning submission only.
Dimensions are to be verified on site prior to construction
Ordnance Survey Data reproduced by permission of Ordnance Survey®, on behalf of Her Majesty's Stationery Office. © Crown Copyright. All rights reserved.

- Key:**
- Existing school perimeter
 - New school boundary
 - Existing school
 - Existing school entrances
 - Strip of Housing open space land to be appropriated

Rev	Date	Prep/Check	Description

Penoyre & Prasad
28-42 Banner Street
London EC1Y 8QE
020 7250 3477
penoyreprasad.com

Client
Royal Borough of Kensington and Chelsea
Project
Barlby New Schools

Drawing Title
**Existing School Site Plan
Land Added to School Site**

Status
Planning
Date
10.10.2018 Scale
1:1250 @ A3
Drawing Number
654-PL-149 Revision

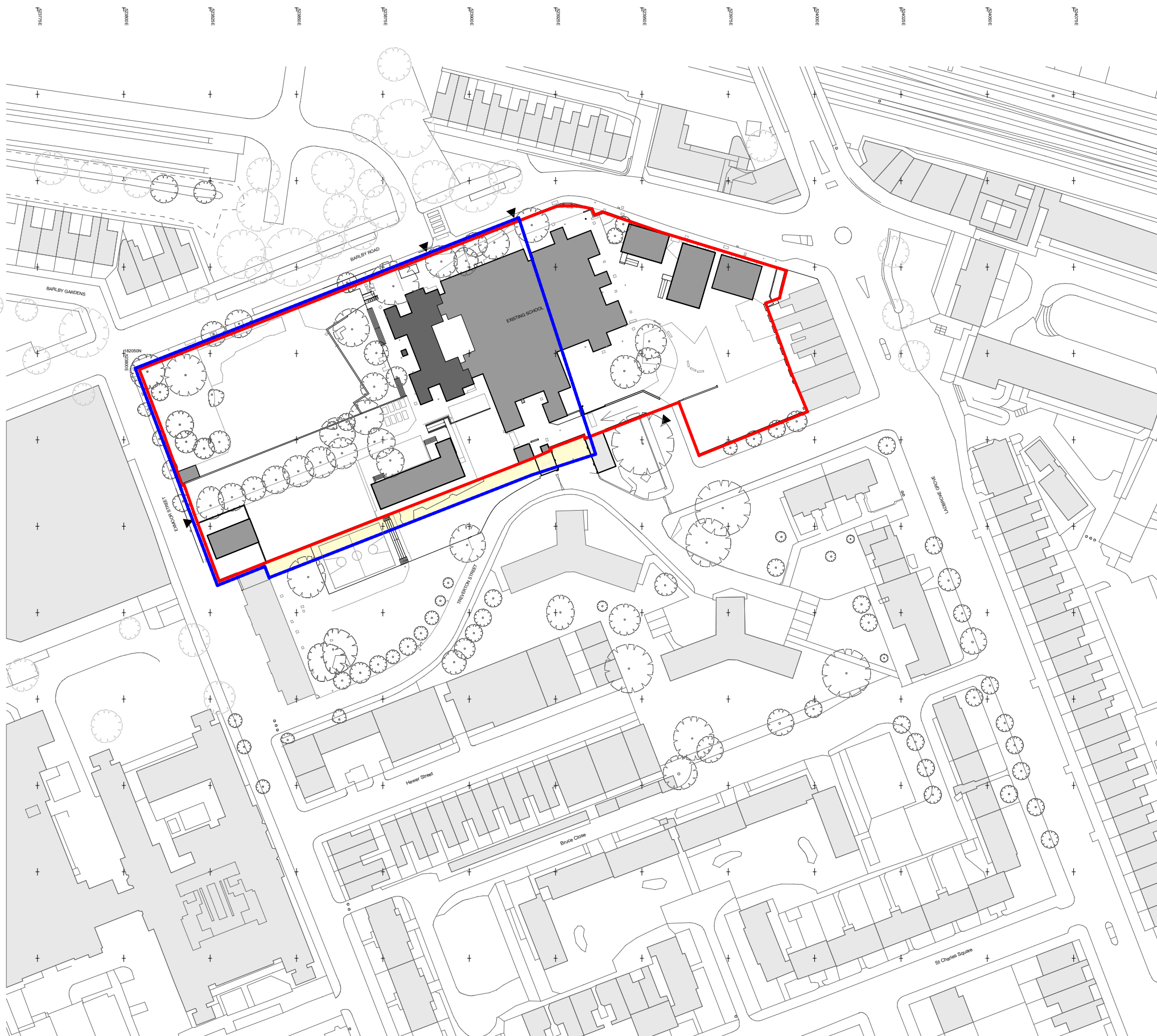

Ordnance Survey (c) Crown Copyright 2015. All rights reserved. Licence number 100022432
Crown Copyright. All rights reserved. Licence number AR100000013, 14 Jan 2015

01 Existing Site Plan
1:1250

